

Trade Tower

Spectrum

HO SCALE

cityscenesTM

ASSEMBLY INSTRUCTIONS



Item #88007

roof and sidewalk detailing accessories

Your kit is complete with Roof and Sidewalk Detailing Accessories. Some, such as Roof Vents Parts (11) and Fire Hydrants Parts (8), do not require assembly. Others require assembly as shown.

After assembly, position the accessories on or around your building as required.
Suggested locations:

BUILDING ROOF TOP

Roof Vents
Rotary Exhaust Vents

SIDEWALK

Mail/Express Boxes
Fire Hydrants

NOTE: Dry Fit each part before assembly. Glue should be applied sparingly to the assembly tabs.
For added detail, parts can be individually painted before assembly.

MAILBOXES

1. Assemble Mailbox Halves (6) and (7).

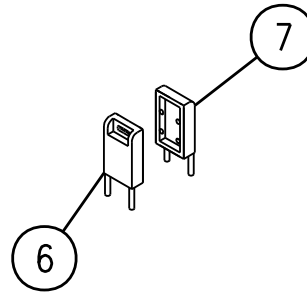

ROTARY EXHAUST VENTS

1. Assemble Rotary Vent (9) to Base (10).

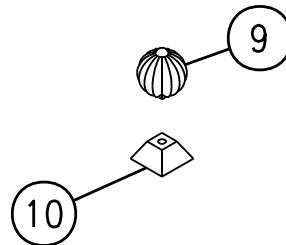

AFTER YOU COMPLETE THIS ASSEMBLY STEP, YOU WILL HAVE SOME PARTS LEFT OVER. THESE PARTS ARE NOT NEEDED. YOU MAY USE PARTS FOR SCRATCH BUILDING PROJECTS.

READ PRIOR TO ASSEMBLY

TO ENHANCE THE AESTHETIC AND REALISTIC QUALITIES OF THIS BUILDING, PARTS HAVE BEEN DESIGNED AND MANUFACTURED IN SCALE PROPORTIONS. AS A RESULT, SOME PARTS ARE FRAGILE AND REQUIRE CARE IN ASSEMBLY. THEREFORE... EASY DOES IT. AS WITH ANY MODEL BUILDER KIT, A DEGREE OF PATIENCE IS REQUIRED TO ACHIEVE THE BEST RESULTS.

ASSEMBLY HINTS

- Read through these instructions and examine the parts supplied to familiarize yourself with all aspects of the building prior to assembly.
- Remove the parts as needed, not at random.
- To remove the parts from the sprues, cut, not break, each part.
- However, when removing Clear Parts from the sprue, bend the Clear Part back and forth. The bending action will safely remove part from sprue.
- If you choose to paint any parts, we suggest you do so prior to assembly.
- To ensure a nice, tight fit, carefully remove all excess sprue marks with a modeling knife or hobby file. This is a necessity or parts will not fit properly.
- Follow the sequence guide to ensure correct placement of the parts.
- VERY IMPORTANT - Before gluing, dry fit the parts.
- Use glue sparingly, especially when assembling Window Frames and Clear Parts. These parts have been designed to tight tolerances, in many cases enabling you to trap the Window Frames between the Wall and the Clear Part, and therefore require only "tack" gluing.
- All Window Clear Parts are marked "**THIS SIDE UP.**" For proper assembly, be sure "**THIS SIDE UP**" is facing you and legible when assembling. This will properly orient the part to slide easily onto locator tabs.
- Prior to assembling a Window Clear Part, be sure you have matched "Open" and "Closed" Window Frames with "Open" and "Closed" (solid) Clear Parts (if applicable to your model). The Clear Parts, once mounted on the mounting tab, are difficult to remove from the tab. If the Clear Part must be removed, gently pry the Clear Part upward until loose. When mounting Window Frames, be careful that they are positioned correctly, according to the instructions of your specific model.
- Prior to assembly, brick areas can be enhanced by adding mortar (if applicable for your model). We use Robert's Brick Mortar Formula. It's easy to apply and looks great. For product information, contact Robert's Products Co., P.O. Box 270057, Milwaukee, WI 53227.
- Use the full-color box lid as a helpful guide during assembly.
- Now it's time to break ground for the construction of your Cityscenes™ building. Take your time and have fun!

RECOMMENDED TOOLS

Modeling Knife - For removing parts from sprue and trimming.

Hobby File - For removing sprue marks.

Glue - Preferably a liquid, easy-to-brush adhesive. Use it sparingly.

3/8 - 1/2" Brush - Helpful in spreading glue on larger areas.

Tweezers - For assembling smaller parts.

Sandpaper or Emery Board - For removing flash.

tower and roof assembly

When assembling Tower Walls, carefully align Wall tabs with each Wall. Dry fit each part prior to applying glue. Apply glue sparingly on the assembly tabs and lower backside edge of walls before assembling to main building Roof (6). Make sure that the TEXTURED side of Roof (6) with the marking "THIS SIDE UP" is exposed.

ASSEMBLE IN SEQUENCE:

1. Front Wall (7) to assembly tabs Roof (6).
2. Right Side Wall (8) to assembly tabs Roof (6) and Front Wall (7).
3. Back Wall (7) to assembly tabs Roof (6) and Right Side Wall (8).
4. Left Side Wall (8) to assembly tabs Roof (6), Front Wall (7) and Back Wall (7).
5. Roof (6) (with assembled Tower) to assembly tabs of all four Walls of Main Building.
6. Roof (15) to assembly tabs of all four Walls of Tower.

NOTE: When assembling the Roof, assure that the TEXTURED side is exposed.

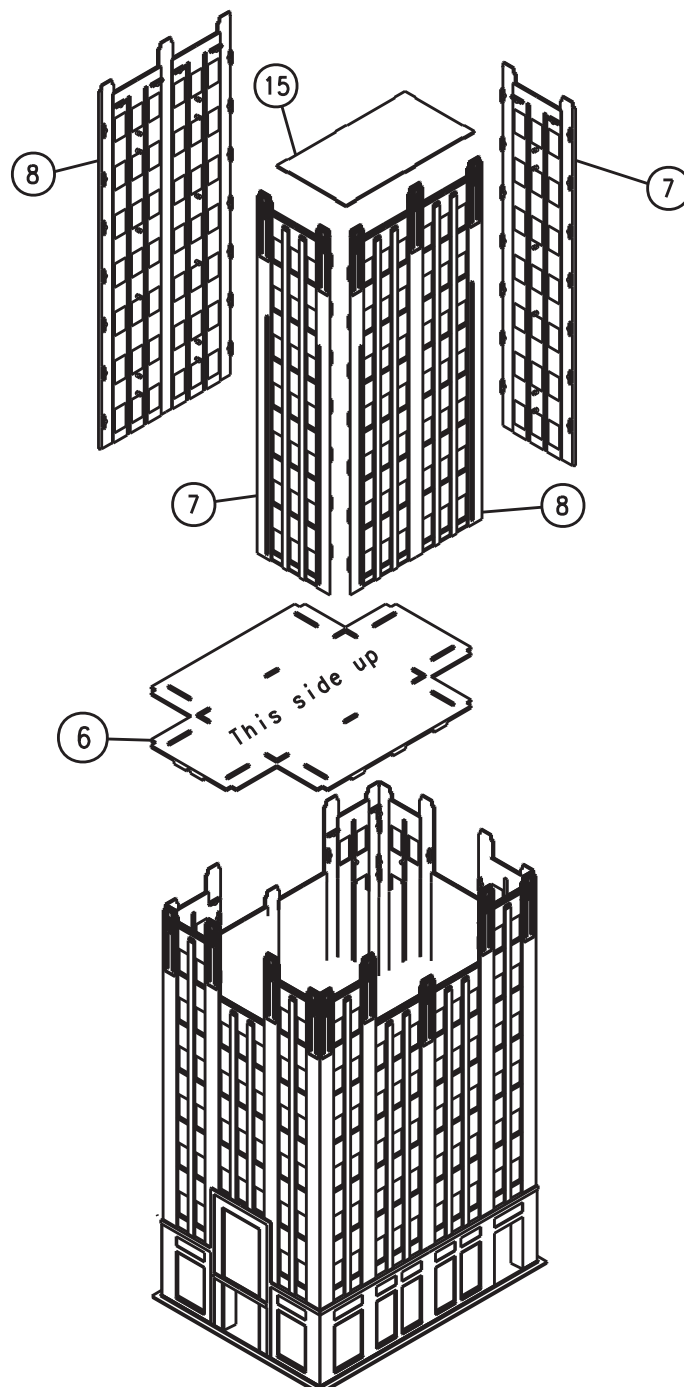

main wall sub assemblies (continued)

ASSEMBLE WALL (3) IN SEQUENCE:

DOOR AND WINDOWS:

1. One Piece Door (18) to Wall (3).
NOTE: Door (18) is properly positioned when the bottom of the door is flush with the bottom of Wall (3). Clear Part mounting tabs of Door (18) should face inside of building.
2. Four pieces "Open" Windows (24) to Wall (3).
3. Eight pieces "Closed" Windows (23) to Wall (3).
4. Three pieces "Open" Windows (26) to Wall (3).
5. Seven pieces "Closed" Windows (25) to Wall (3).

CLEAR PARTS:

1. Four pieces "Open" Clear Part (28) to Wall (3).
2. Two pieces "Open" Clear Part (30) to Wall (3).
3. One piece "Open" Clear Part (38) to Wall (3).
4. One piece "Closed" Clear Part (29) to Wall (3).
5. One piece Door Clear Part (35) to Wall (3).
6. One piece Display Window Clear Part (32) to Wall (3).
7. Two pieces Display Window Clear Part (33) to Wall (3).

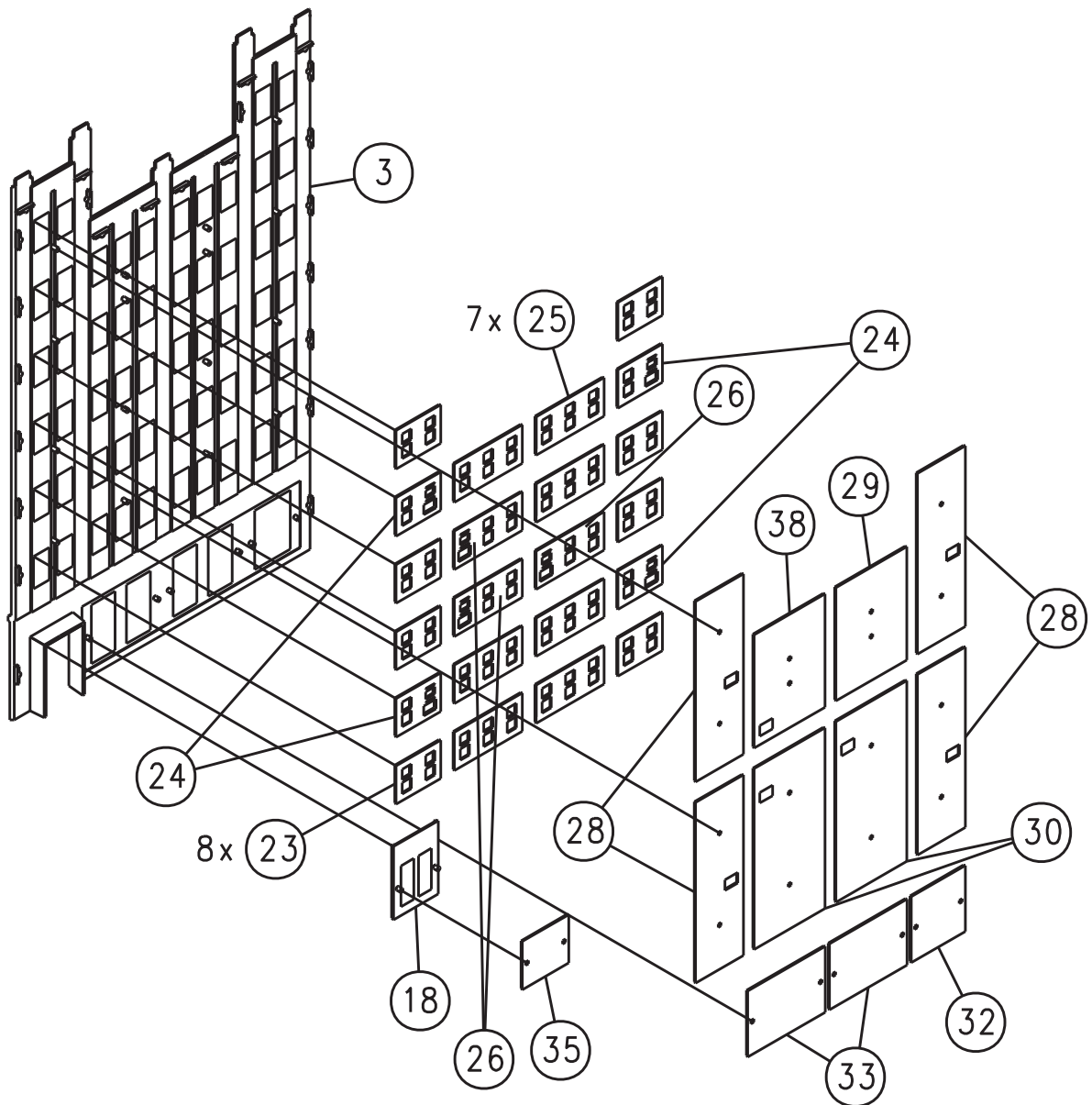

tower and annex wall sub assemblies (continued)

ASSEMBLE FOUR PIECES WALL (12) IN SEQUENCE:

WINDOWS:

1. One piece "Open" Window (22) to Wall (12).
2. Three pieces "Closed" Windows (21) to Wall (12).

CLEAR PARTS:

1. One piece "Open" Clear Part (39) to Wall (12).

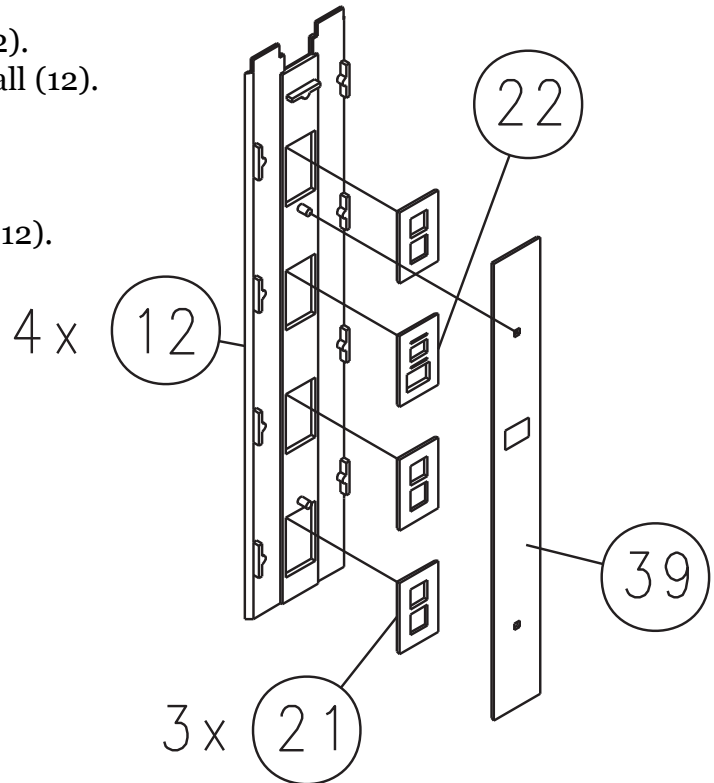

ASSEMBLE FOUR PIECES WALL (13) IN SEQUENCE:

WINDOWS:

1. Two pieces "Open" Windows (22) to Wall (13).
2. Two pieces "Closed" Windows (21) to Wall (13).

CLEAR PARTS:

1. One piece "Open" Clear Part (27) to Wall (13).

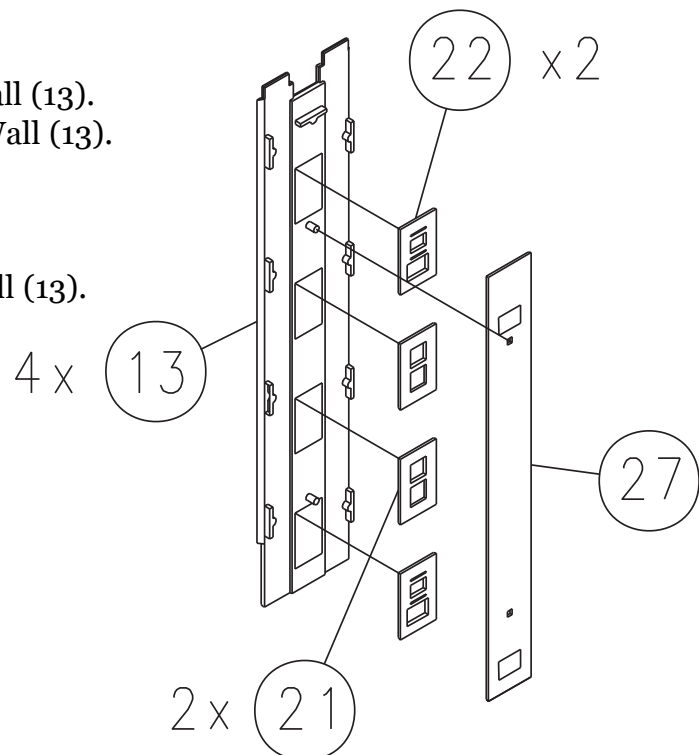
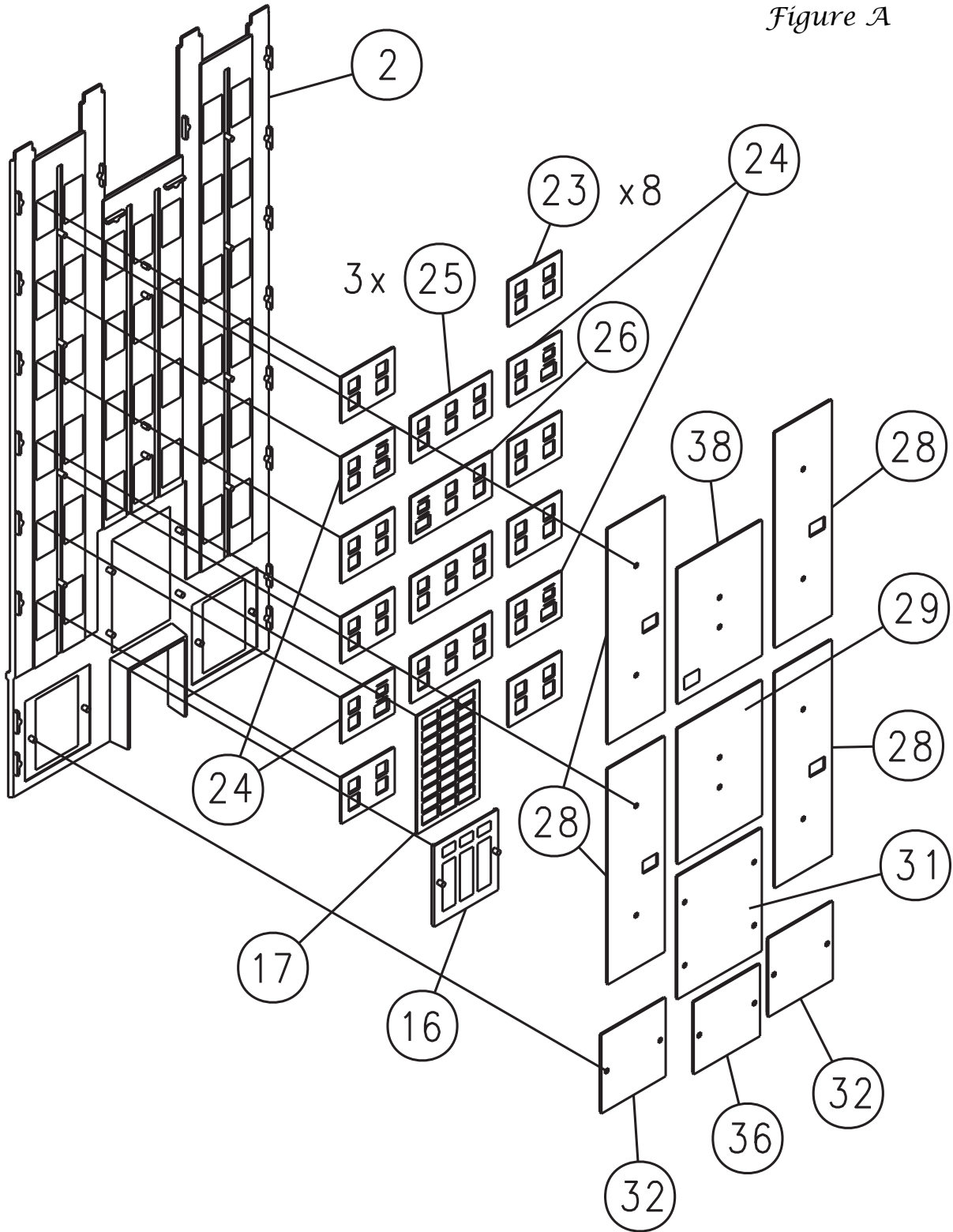

Figure A



main wall sub assemblies (continued)

ASSEMBLE WALL (5) IN SEQUENCE:

DOORS AND WINDOWS:

1. One Piece Freight Door (37) and One Piece Door (19) to Wall (5).
NOTE: Freight Door (37) and Door (19) are properly positioned when bottom of Door is flush with bottom of Wall (5).
2. Four pieces "Open" Windows (24) to Wall (5).
3. Eight pieces "Closed" Windows (23) to Wall (5).
4. Two pieces "Open" Window (26) to Wall (5).
5. Three pieces "Closed" Windows (25) to Wall (5).
6. One piece "Closed" Window (20) to Wall (5).

CLEAR PARTS:

1. Four pieces "Open" Clear Part (28) to Wall (5).
2. One piece "Open" Clear Part (38) to Wall (5).
3. One piece "Open" Clear Part (30) to Wall (5).
4. One piece "Closed" Clear Part (34) to Wall (5).
NOTE: Clear Part (34) covers Door (19), Door (37) and Window (20).

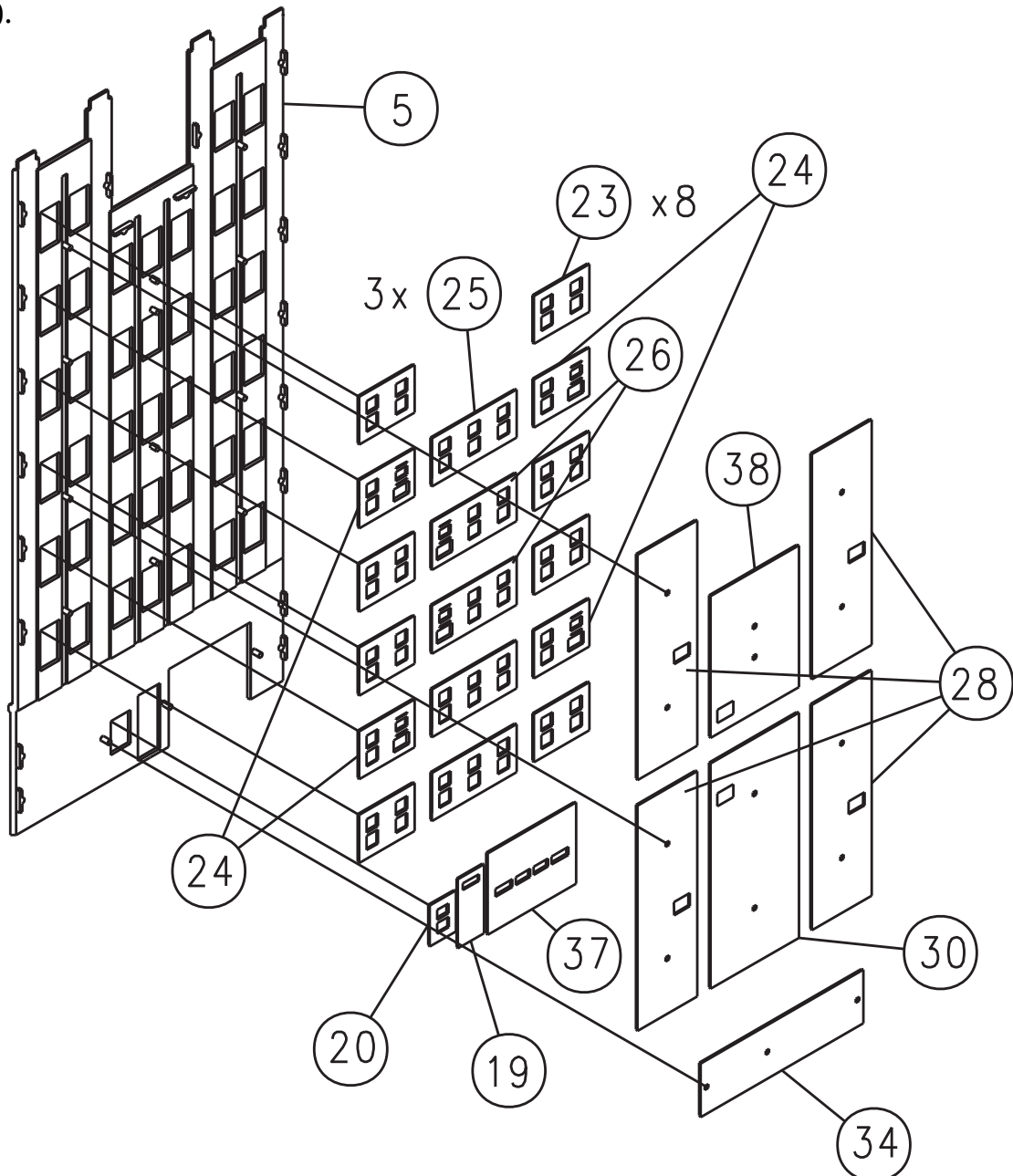

tower and annex wall sub assemblies

Assemble TWO each of Walls (7) and (8). Completely assemble each wall before beginning assembly of another wall. Assemble all parts to **BACKSIDE** of the Walls. It is recommended that you position ALL windows into the wall, then assemble ALL Clear Parts. When properly positioned, the Windows fit solidly into wall openings; the Clear Part(s) fit onto locator tabs extending from Wall. Prior to final assembly, make sure you have properly matched "Open" and "Closed" Windows with "Open" and "Closed" Clear Parts. If desired, use glue on Windows and Clear Parts. **IMPORTANT** - Use the diagrams to properly locate "Open" and "Closed" Windows and Clear Parts.

ASSEMBLE TWO PIECES WALLS (7) IN **SEQUENCE**:

WINDOWS:

1. Two pieces "Open" Windows (26) to Wall (7).
2. Five pieces "Closed" Windows (25) to Wall (7).

CLEAR PARTS:

1. One piece "Open" Clear Part (38) to Wall (7).
2. One piece "Closed" Clear Part (29) to Wall (7).
3. One piece "Open" Clear Part (30) to Wall (7).

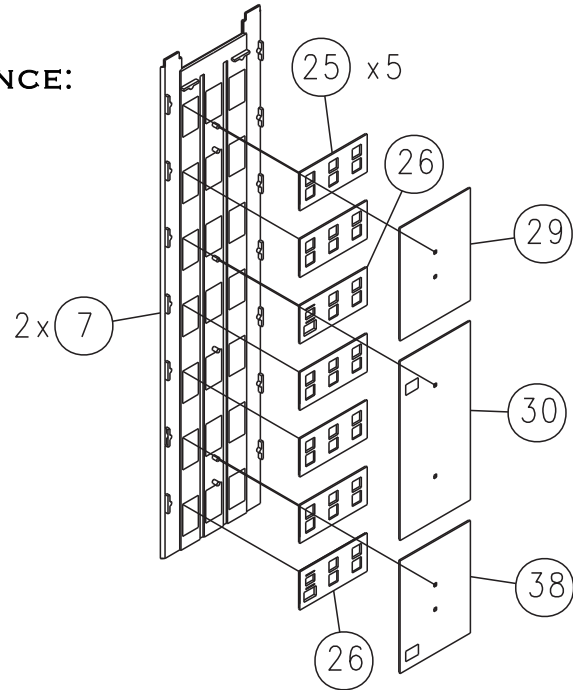

ASSEMBLE TWO PIECES WALL (8) IN **SEQUENCE**:

WINDOWS:

1. Three pieces "Open" Windows (26) to Wall (8).
2. Eleven pieces "Closed" Windows (25) to Wall (8).

CLEAR PARTS:

1. One piece "Open" Clear Part (38) to Wall (8).
2. Three pieces "Closed" Clear Part (29) to Wall (8).
3. Two pieces "Open" Clear Part (30) to Wall (8).

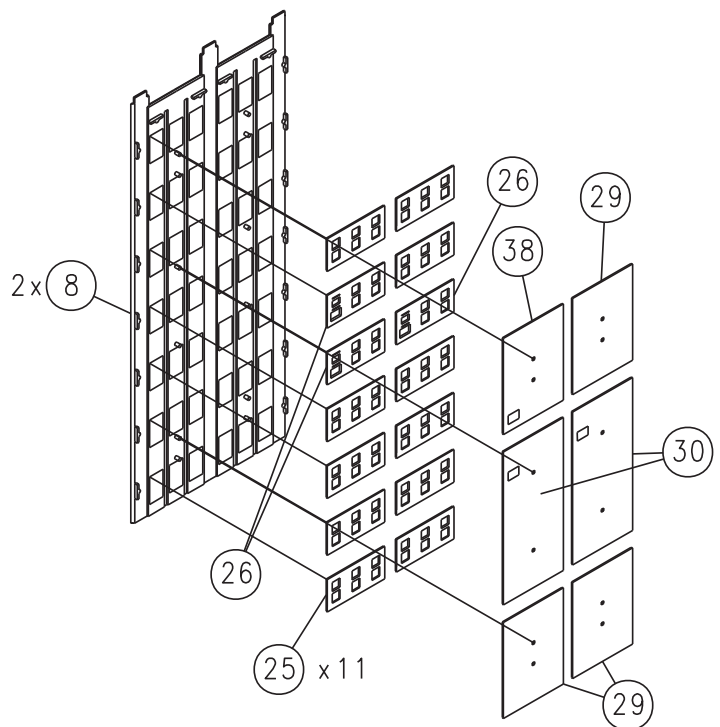

main wall sub assemblies (continued)

ASSEMBLE WALL (2) IN SEQUENCE:

See Figure A.

DOOR AND WINDOWS:

1. One Piece Door (16) to Wall (2).

NOTE: Door (16) is properly positioned when the bottom of the door is flush with the bottom of Wall (2). Raised edges of Door (18) should be positioned on the outside of door opening.

2. Four pieces "Open" Windows (24) to Wall (2).
3. Eight pieces "Closed" Windows (23) to Wall (2).
4. One piece "Open" Window (26) to Wall (2).
5. Three pieces "Closed" Windows (25) to Wall (2).
6. One piece Atrium Window (17) to Wall (2).

CLEAR PARTS:

1. Four pieces "Open" Clear Part (28) to Wall (2).
2. One piece "Open" Clear Part (38) to Wall (2).
3. One piece "Closed" Clear Part (29) to Wall (2).
4. One piece Atrium Clear Part (31) to Wall (2).
5. One piece Door Clear Part (36) to Wall (2).
6. Two pieces Display Window Clear Part (32) to Wall (2).

main building assembly

When assembling Walls, carefully align Wall tabs with each Wall. Dry fit each part prior to applying glue. Apply glue sparingly on the assembly tabs and lower backside edge of walls before assembling to Base (1).

ASSEMBLE IN SEQUENCE:

1. Front Wall (2) to Base (1). The Front of Base (1) is identified by the "FRONT" marking engraved on base.
2. Right Side Wall (3) to Base (1) and Front Wall (2).
3. Back Wall (5) to Base (1) and Wall (3).
4. Left Side Wall (4) to Base (1) and Front Wall (2) and Back Wall (5).

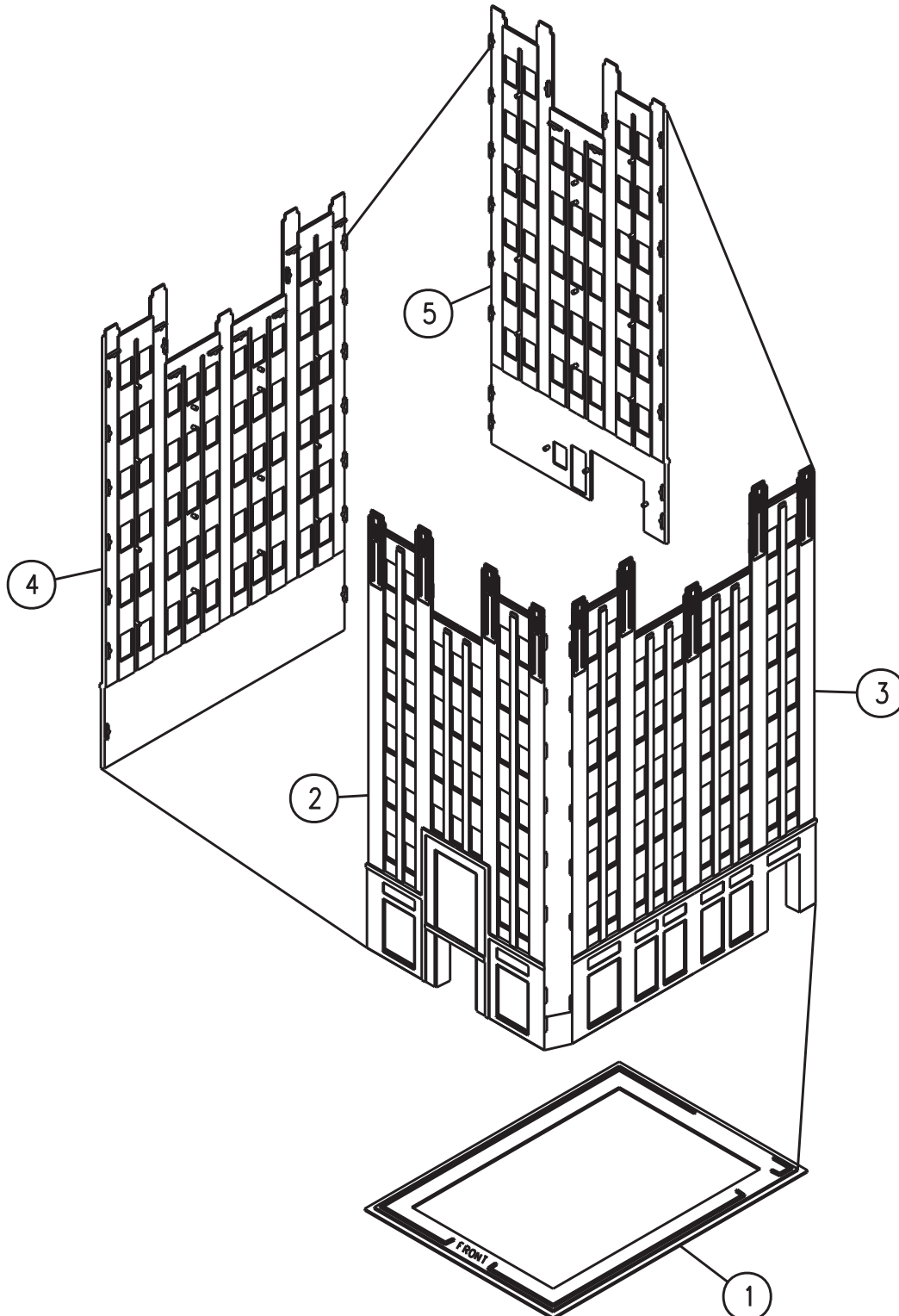

main wall sub assemblies

Completely assemble each wall before beginning assembly of another wall. Assemble all parts to **BACKSIDE** of the Walls. It is recommended that you position **ALL** windows into the wall, then assemble **ALL** Clear Parts. When properly positioned, the Windows and Doors (if applicable) fit solidly into wall openings; the Clear Part(s) fit onto locator tabs extending from Wall. Prior to final assembly, make sure you have properly matched "Open" and "Closed" Windows with "Open" and "Closed" Clear Parts. If desired, use glue on Windows and Clear Parts.

IMPORTANT - Use the diagrams to properly locate "Open" and "Closed" Windows and Clear Parts.

ASSEMBLE WALL (4) IN SEQUENCE:

WINDOWS:

1. Four pieces "Open" Windows (24) to Wall (4).
2. Eight pieces "Closed" Windows (23) to Wall (4).
3. Three pieces "Open" Windows (26) to Wall (4).
4. Seven pieces "Closed" Windows (25) to Wall (4).

CLEAR PARTS:

1. Four pieces "Open" Clear Part (28) to Wall (4).
2. Two pieces "Open" Clear Part (30) to Wall (4).
3. One piece "Open" Clear Part (38) to Wall (4).
4. One piece "Closed" Clear Part (29) to Wall (4).

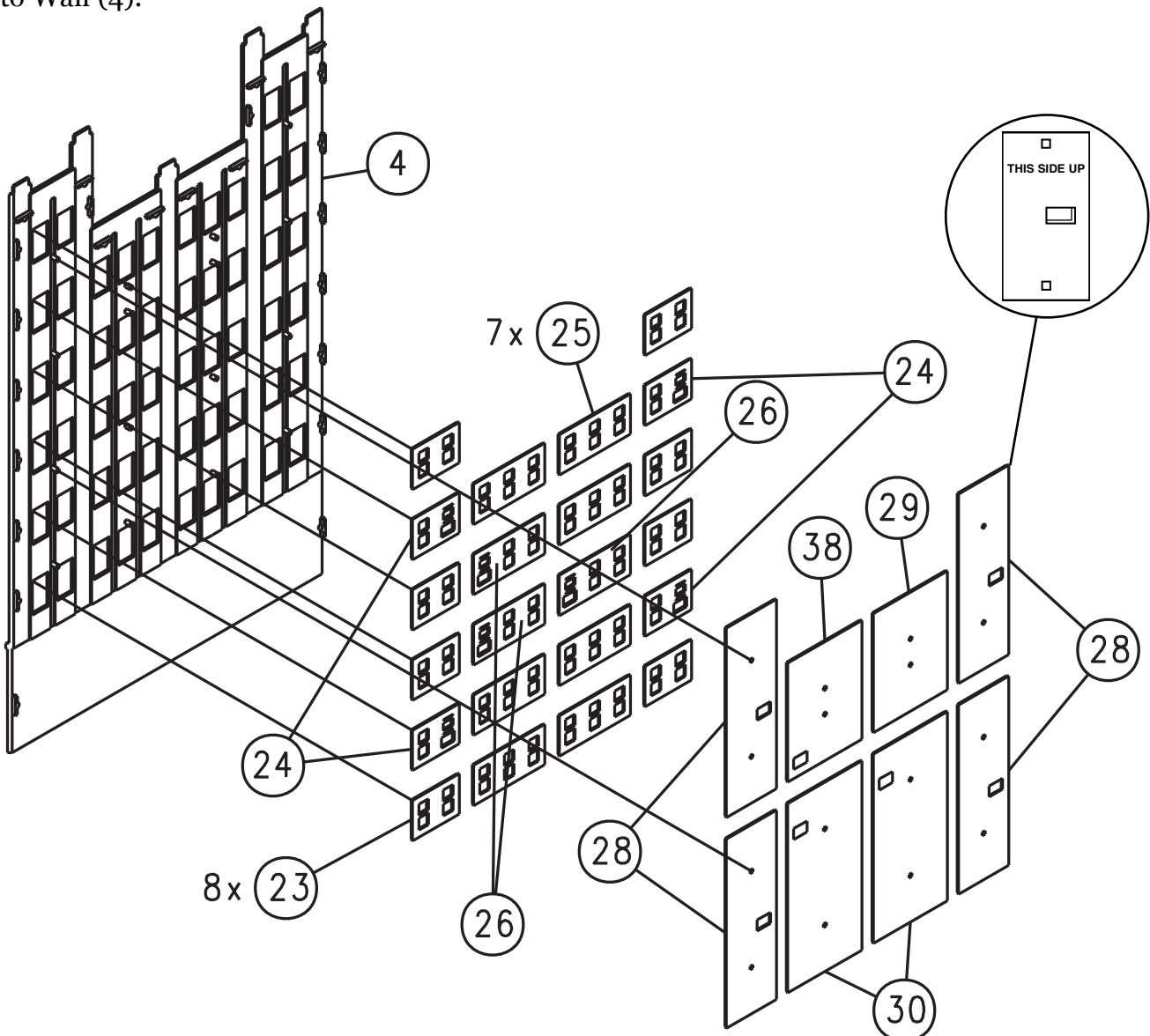

annex tower assembly

Assemble FOUR pieces Annex Towers to the Tower assembly. Use the Photograph to determine location and positioning. Complete ONE Annex Tower assembly at a time. Repeat the same assembly sequence for all four Annex Towers.

ASSEMBLE IN SEQUENCE:

1. Annex Wall (10) to Tower.
2. Annex Wall (11) to Tower.
3. Annex Base (9) to Annex Wall (10) and Annex Wall (11).
NOTE: When assembling the Annex Base (9) assure that the TEXTURED side is exposed.
4. Annex Wall (12) to Wall (10) and Base (9).
5. Annex Wall (13) to Walls (11) and (12) and Base (9).
6. Roof (14) to Annex Wall Assembly.
NOTE: When assembling Roof (14) assure that the TEXTURED side is exposed.

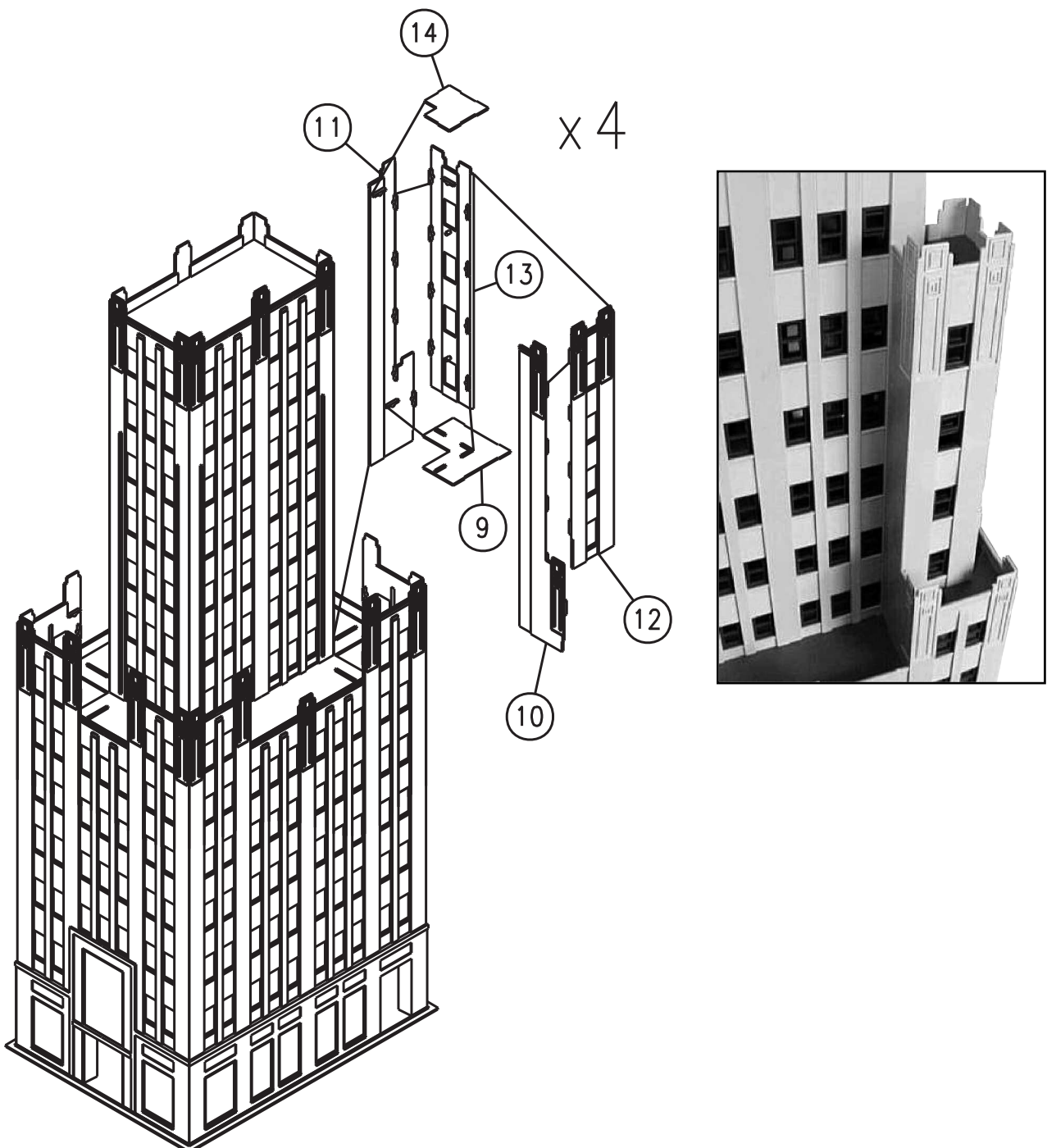

sidewalk assembly

Depending on the location of this building on your layout, you have the option of placing Sidewalks on one, two, three, or four sides of this building. Cut each Sidewalk section (88) to the proper length for an appropriate fit. Use Corners (89) to connect the straight Sidewalk sections (88).

NOTE: The Sidewalks included with this kit are compatible with the Street and Sidewalk System made by the WM. K. Walthers Co., Milwaukee, WI.

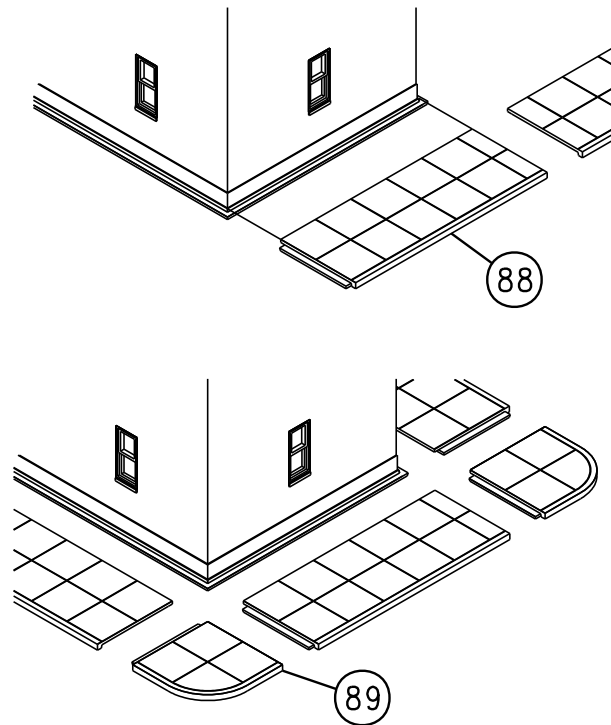

Decals

Custom decals have been included with your kit and can be applied at your discretion. Application directions are provided on the back of the decal envelope.

DAMAGED OR MISSING PARTS:

We take great care in ensuring that all parts are present and in good condition. In the unlikely event that a part is missing or damaged, our Service Department will be happy to assist you. For more information contact:



Service Department
Bachmann Industries, Inc.
1400 East Erie Avenue
Philadelphia, Pennsylvania 19124

Phone: 1-800-356-3910



Bachmann Industries, Inc., 1400 East Erie Avenue, Philadelphia, PA 19124
www.bachmanntrains.com
Printed in Denmark.