

# Ambassador Hotel

*Spectrum*<sup>®</sup>

HO SCALE

**cityscenes**<sup>™</sup>

ASSEMBLY INSTRUCTIONS



**Item #88002**

## ROTARY EXHAUST VENTS

1. Assemble Roof Vent (9) to Base (10).

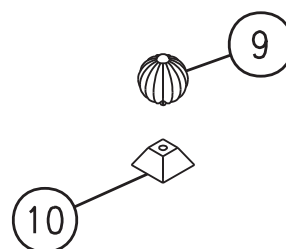

## ROOF ACCESS DOOR

**NOTE:** Glue should be applied sparingly to all parts.

ASSEMBLE IN SEQUENCE:

1. Door (12) to Wall (13).
2. Wall (15) to Front Wall (13).
3. Wall (16) to Front Wall (13).
4. Roof (14) must be bent slightly downward to the contours of Walls (13), (15), and (16). Once bent, assemble Roof (14) to Walls (13), (15), and (16).

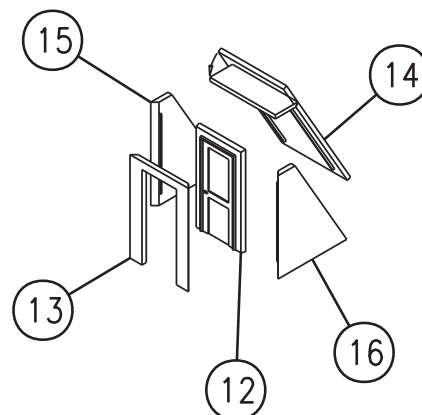

## ROOF WATER TANK

**NOTE:** Glue should be applied sparingly to all parts

ASSEMBLE IN SEQUENCE:

1. Two pieces of Roof Support (18) to two pieces of Cross Braces (19).
2. Tank Base (17) to Braces (18) and (19).
3. Tank Top (20) to Tank Main Body (21).
4. Prior to final assembly of Tank to Base, allow glue on Base assembly to dry. After glue has dried, assemble Tank to Base.

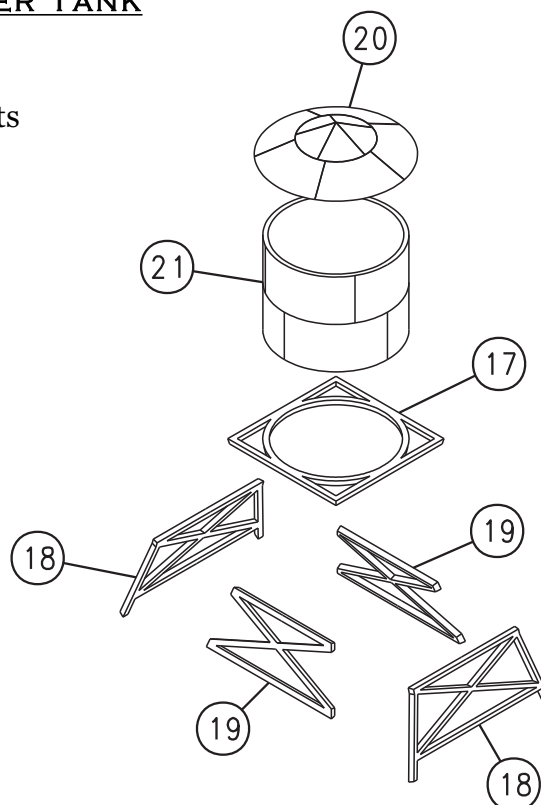

AFTER YOU COMPLETE THIS ASSEMBLY STEP, YOU WILL HAVE SOME PARTS LEFT OVER. THESE PARTS ARE NOT NEEDED. YOU MAY USE PARTS FOR SCRATCHBUILDING PROJECTS.

## ground floor wall sub assemblies

Assemble all parts to BACKSIDE of the Walls. When properly positioned, the Windows fit solidly into wall window opening; the Clear Part(s) fit onto locator tabs extending from Wall and, where windows are required, trap the windows in place. If desired, use glue on Windows and Clear Parts.

### ASSEMBLE IN SEQUENCE:

1. Two pieces Clear Part (54) to Wall (1).
2. Four pieces Clear Part (54) to Wall (16).
3. Two pieces Clear Part (54) to Wall (4).
4. Two pieces Clear Part (54) to Wall (13).
5. Two pieces Clear Part (54) to Wall (5).
6. Two pieces Clear Part (53) to Main Entrance Wall (10).
7. Three pieces Windows (40) into openings Brick Wall (21).  
Three pieces Clear Part (51) onto Brick Wall (21).
8. Windows (42) into opening on Brick Wall (22).  
Clear Part (51) onto Brick Wall (22).

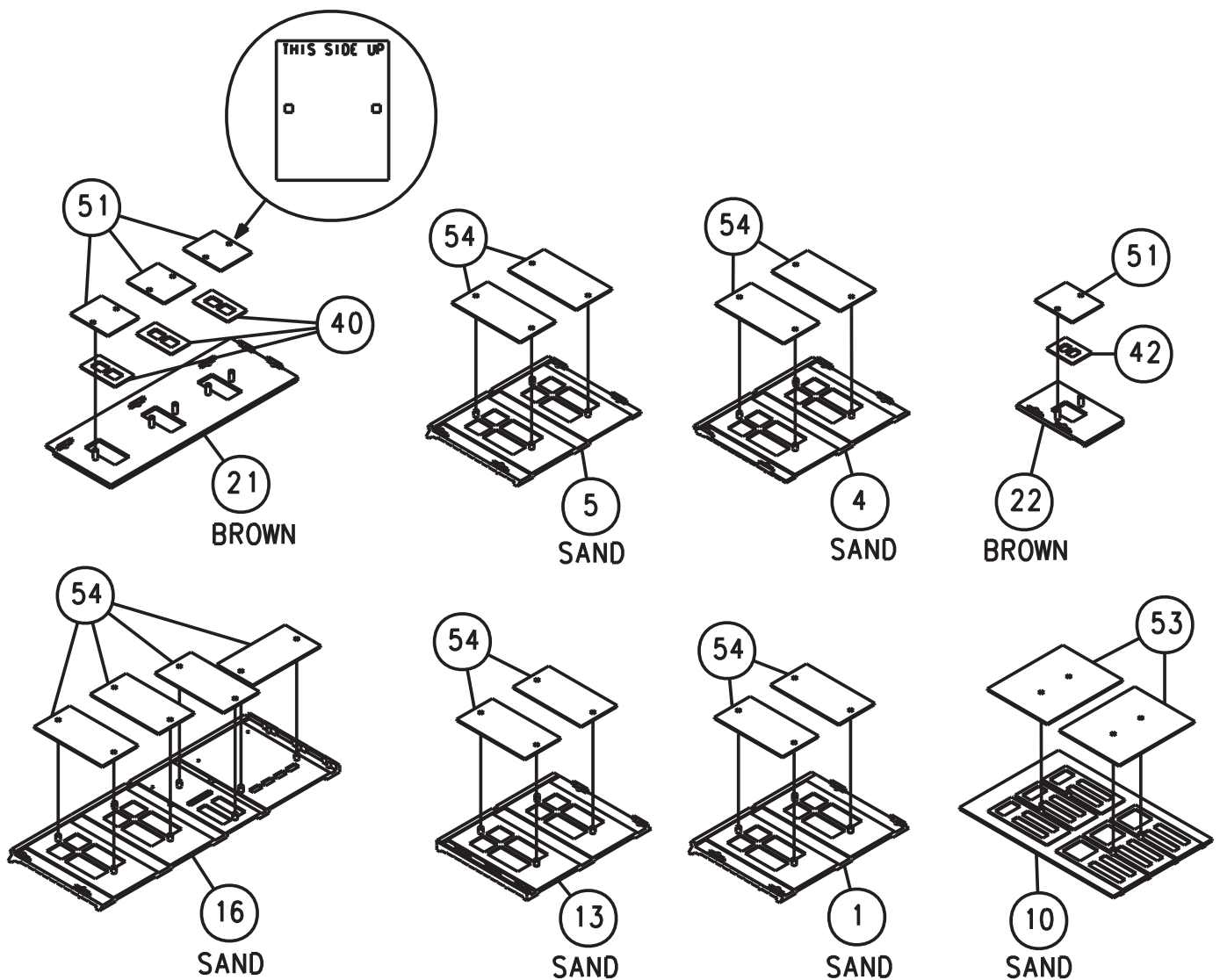

## **sidewalk assembly**

Depending on the location of this building on your layout, you have the option of placing Sidewalks on one, two, three, or four sides of this building. Cut each Sidewalk section (88) to the proper length for an appropriate fit. Use Corners (89) to connect the straight Sidewalk sections (88).

**NOTE:** The Sidewalks included with this kit are compatible with the Street and Sidewalk System made by Wm. K. Walther Co. Milwaukee, WI.

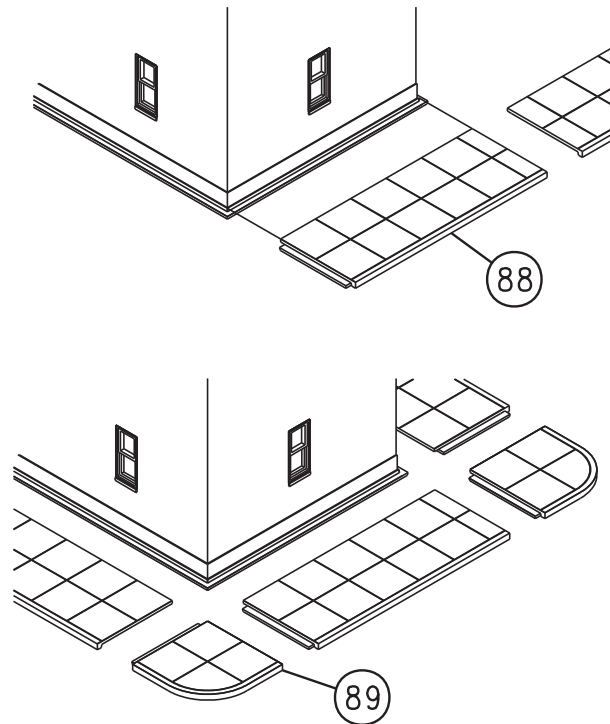

## **back wall assembly**

### FIRE ESCAPES - WALL LOCATOR HOLES:

On the Back Wall (20), locator holes have been designated as "**Optional Holes for Fire Escape.**" If you intend to assemble the four Fire Escapes to the Back Wall, drill out holes prior to window assembly. Drill from the back side, using a .039 (#61) drill bit. You may also use a hobby knife to open the holes, but take care not to make these holes oversized.

### WINDOW ASSEMBLY:

Assemble all parts to BACKSIDE of the Wall. When Properly positioned, the Windows fit solidly into wall window opening; the Clear Part(s) fit onto locator tabs extending from Wall and trap the windows in place. If desired, use glue on Windows and Clear Parts.

Follow the **BACK WALL WINDOW ASSEMBLY TEMPLATE** [See Figure A] for the Window and Clear Part arrangement. The Window's part number is noted in the Window outline. The Clear Part is indicated below the window opening outline, also designating the appropriate mounting posts.

**NOTE:** Prior to beginning Window assembly:

1. Place into position Door (45) and two Loading Dock Doors (44).
2. Begin assembly of Windows and Clear Parts. Windows are inserted first, Clear Parts over Windows.

## **roof and brick cap assembly**

1. Assemble Roof (29) onto Roof Support Bar locator of Top Floor and Main Walls. Use glue sparingly.
2. Assemble Veranda Roof (58) onto locators on back side of Hotel.
3. Assemble Brick Capping in the following sequence, starting with Right Side Wall: Brick Cap (23) and (25) to Veranda Brick Wall. Brick Caps (24), (26), (27) and (28) to Main Roof Bricks.

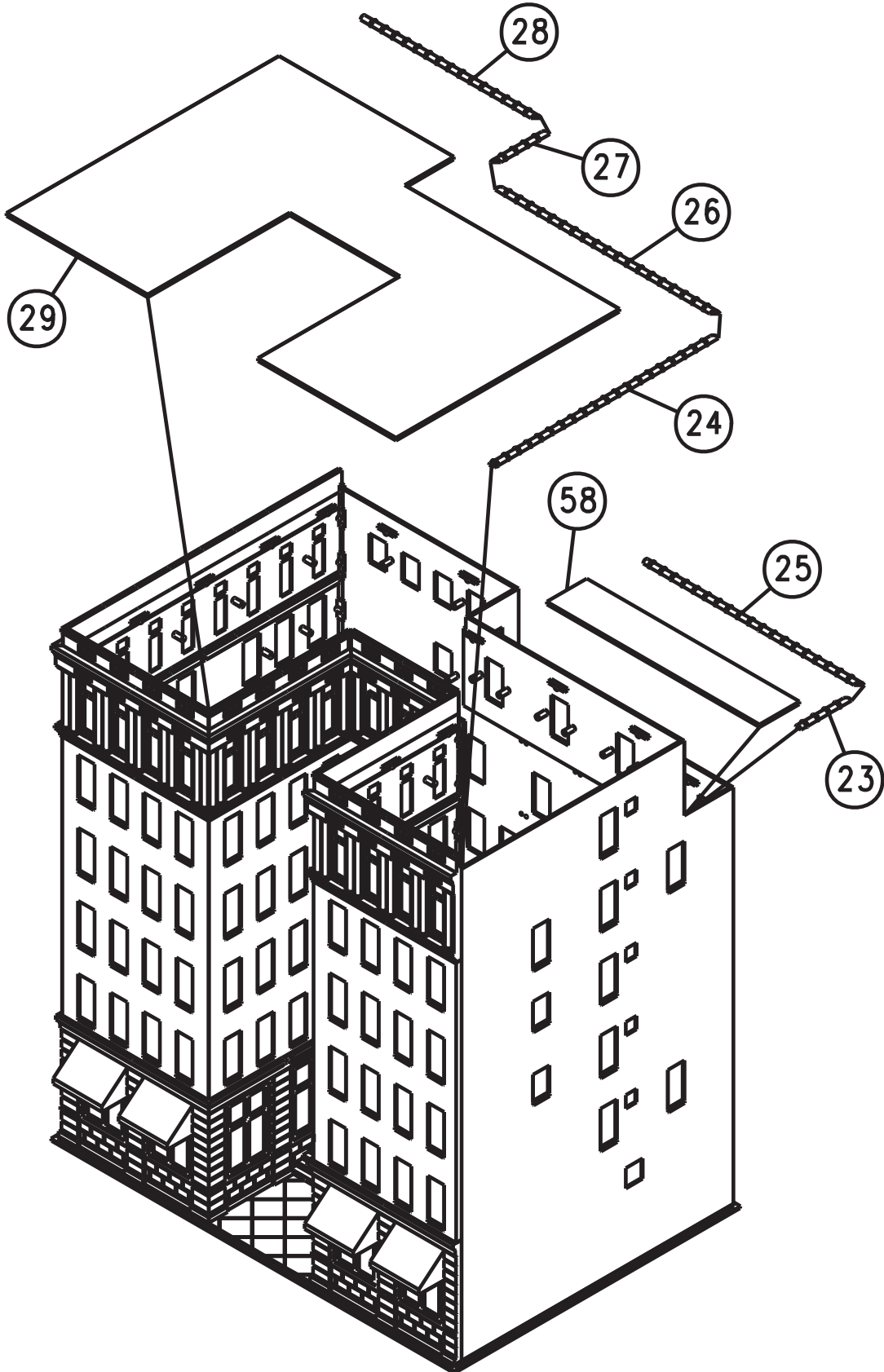

## **top floor walls window assembly**

Assemble Clear Parts to BACKSIDE of the Walls. The Clear Part(s) fit onto locator tabs extending from Wall.

ASSEMBLE CLEAR PARTS TO BACK SIDE OF TOP FLOOR PARTS:

1. Clear Part (48) to Wall (9).
2. Clear Part (48) to Wall (3).
3. Clear Part (48) to Wall (8).
4. Clear Part (48) to Wall (15).
5. Two Clear Parts (48) to Wall (18).
6. Clear Part (49) to Wall (12).

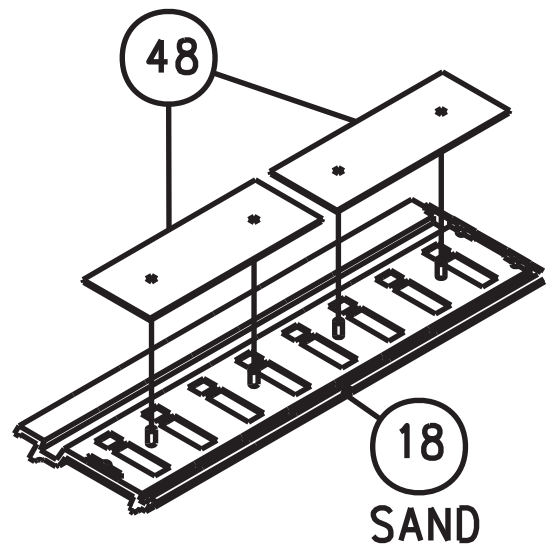
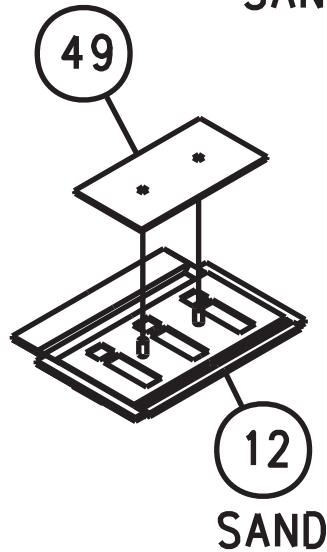
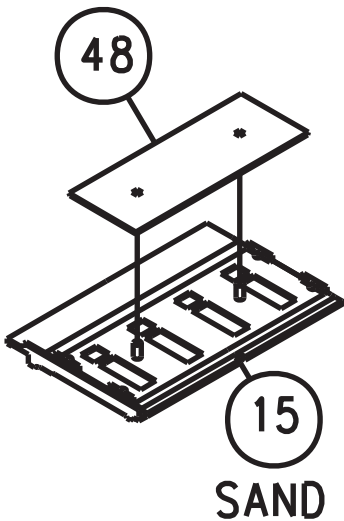
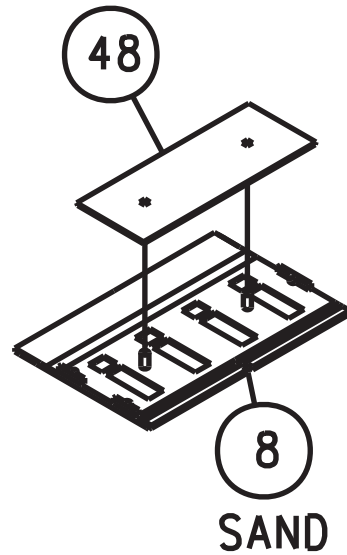
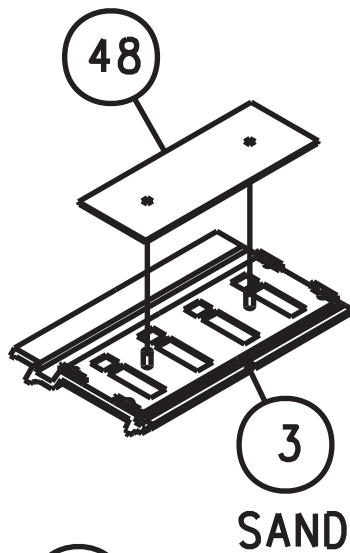
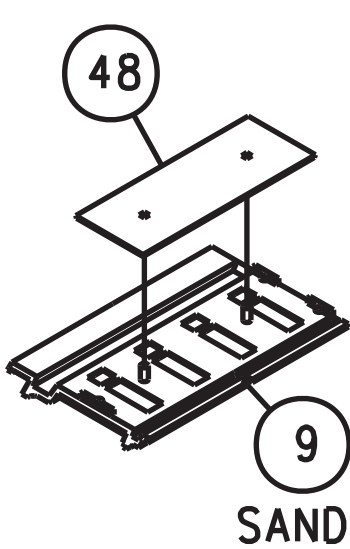

## **top floor wall assembly**

### **ROOF SUPPORT BAR ASSEMBLY:**

Assemble Roof Support Bar Assembly into Top Floor Walls (See Figure B). The Roof Supports are positioned properly in the Wall recess when the flat portion of the Supports face up and the Roof Support Bar is flush with the surface of the Back Side of the Wall.

1. Roof Support (61) into Wall (18).
2. Roof Support (62) into Wall (3).
3. Roof Support (63) into Wall (8).
4. Roof Support (66) into Wall (15).
5. Roof Support (65) into Wall (9).
6. Roof Support (64) into Wall (12).

### **WALL ASSEMBLY:**

The Top Floor Walls are positioned onto the Middle Floor Brick Walls, with the Glue Flange behind the Middle Floor Brick Wall (See Figure B). Apply glue sparingly to the Wall alignment tabs and Glue Flange.

### **ASSEMBLE IN SEQUENCE:**

1. Wall (18) to Left Side Brick Wall.
2. Wall (3) to Front Brick Wall.
3. Wall (8) to Left Interior Brick Wall.
4. Wall (15) to Front Brick Wall.
5. Wall (9) to Right Interior Brick Wall.
6. Wall (12) to Walls (8) and (9). For proper positioning, the side locator tabs on Wall (12) should interlock on back side of Walls (8) and (9).



## **middle floor brick wall window assembly**

Assemble all parts to BACKSIDE of the Walls. When properly positioned, the Windows fit solidly into wall window opening; the Clear Part(s) fit onto locator tabs extending from Wall and trap the Windows in place. If desired, use glue on Windows and Clear Parts.

You have the option of arranging the "Open" and "Closed" Windows however you choose. **IMPORTANT** - Once you determine the location of the "Open" and "Closed" Windows, be sure to match those with "Open" and "Closed" (solid) Clear Parts. A suggested window arrangement is shown.

Assemble Windows and Clear Parts in Brick Walls (7), (6), and (14).

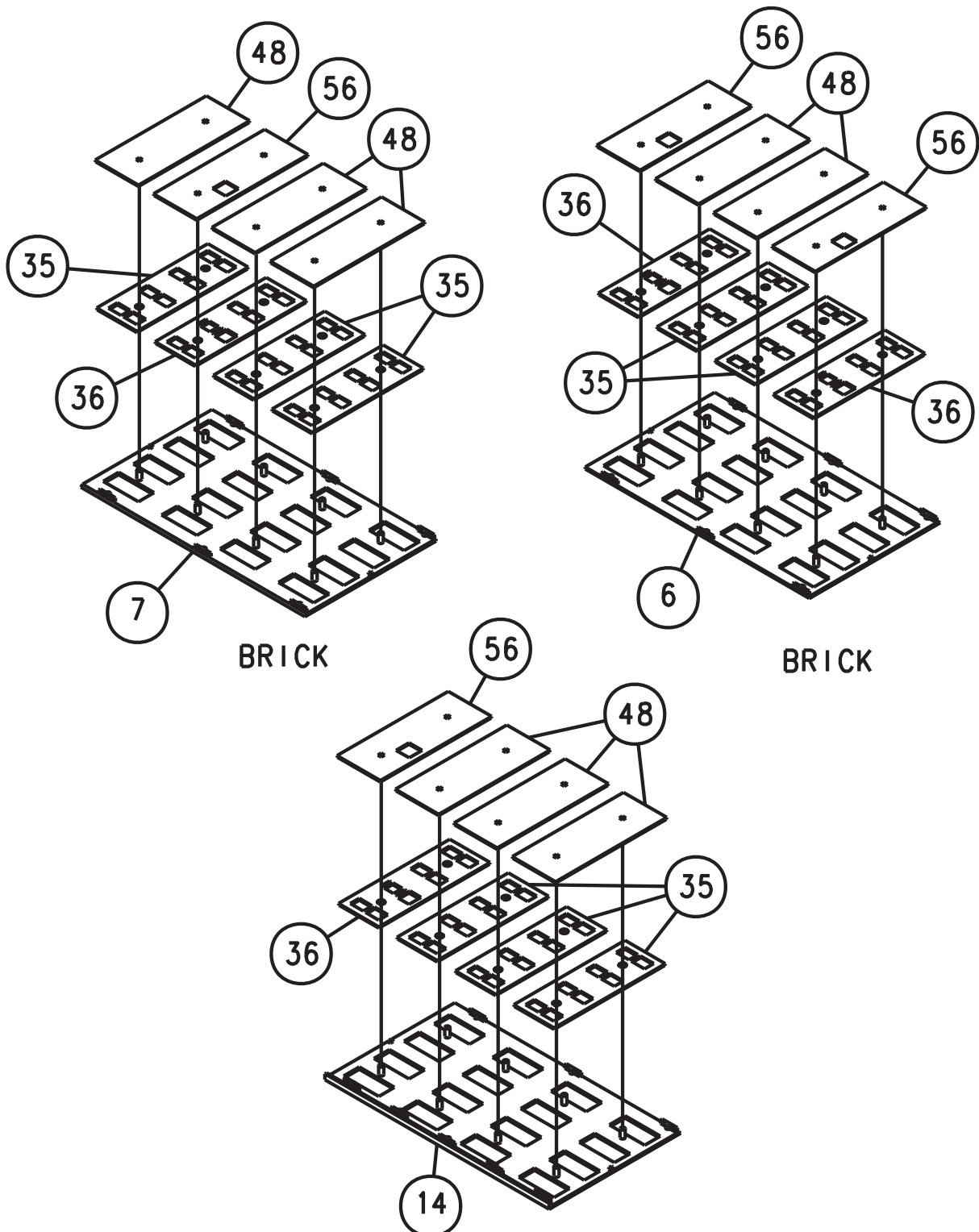

## **ground floor and main wall assembly**

When assembling Walls, carefully align Wall tabs with each Wall. Dry fit each part before applying glue. Apply glue sparingly on the assembly tabs and lower backside edge of wall.

ASSEMBLE THE PARTS AND SUB-ASSEMBLIES IN SEQUENCE:

1. Ground Wall (16) to Base (60).
  2. Ground Wall (1) to Base (60).
  3. Ground Wall (4) to Base (60).
  4. Ground Wall (13) to Base (60).
  5. Ground Wall (5) to Base (60).
  6. Main Entrance Wall (10) to Base (60).  
When positioned properly, the side locator tabs on Main Entrance Wall (10) interlock on back side of Ground Walls (4) and (5).
  7. Front Entrance Balcony Floor (30) into locators on Main Entrance Wall (10) and Ground Floor Walls (4) and (5).
  8. Railing (31) to Front Entrance Balcony Floor (30).
  9. Left Main Side Wall (19) to Base (60).
  10. Main Back Side Wall (20) to Base (60).
  11. Wall (21) to Wall (22), making sure that Walls are assembled at right angle.  
Assemble sub-assembly to Main Walls (19) and (20).
- NOTE:** Be especially careful in joining the long walls (19) and (20).  
With care and patience, an invisible joint can be achieved.

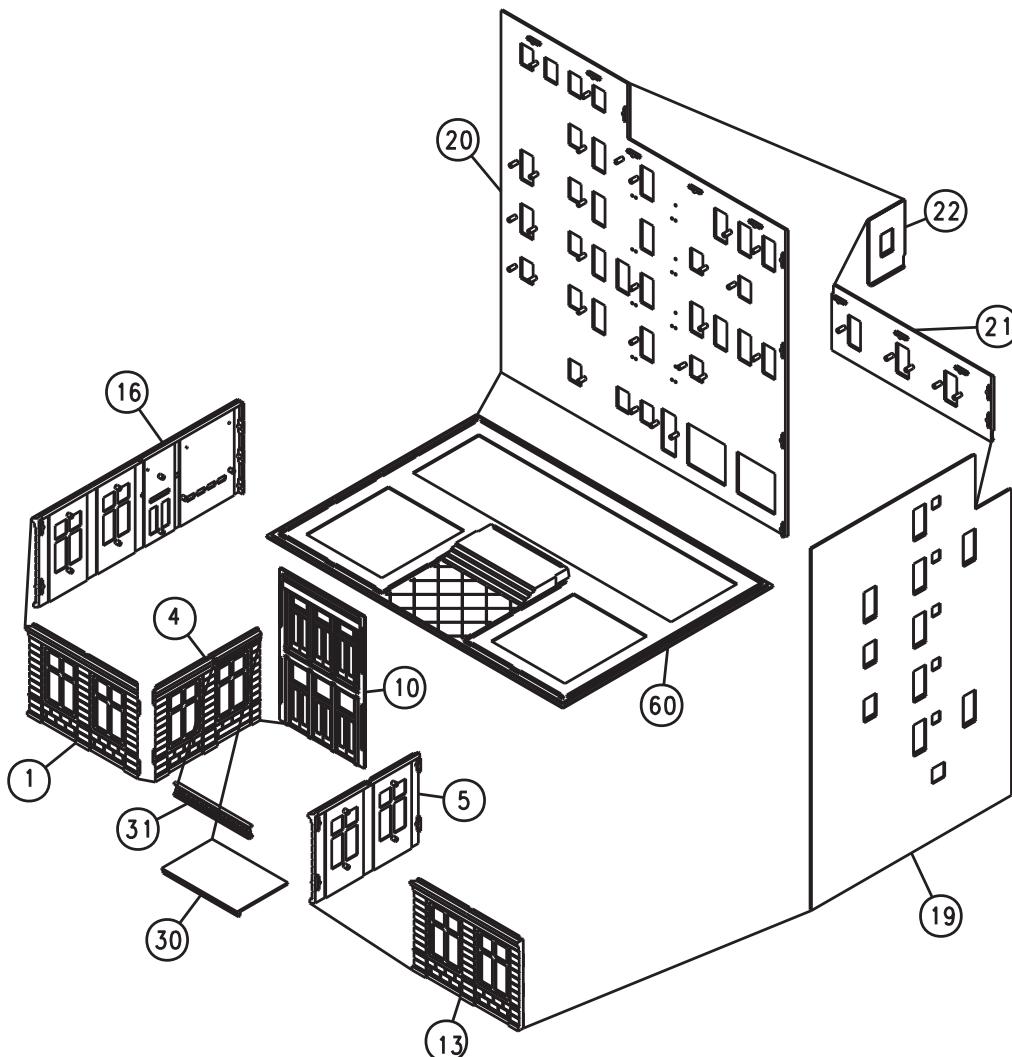

## **middle floors wall assembly and exterior detail parts assembly**

When assembling the Middle Floors Brick Walls to Ground Floor Walls, dry fit each Wall prior to assembly. The Middle Floor Brick Walls, with the exception of Wall (11), are positioned on the outer ledge of the Ground Floor Walls. Apply glue sparingly to the Wall alignment tabs and back side lower edge of the Middle Floor Brick Walls.

### ASSEMBLE IN SEQUENCE:

1. Brick Wall (17) to Lower Floor Wall.
2. Front Wall (2) to Lower Floor Wall.
3. Left Interior Wall (6) to Lower Floor Wall.
4. Front Brick Wall (14) to Lower Floor Wall.
5. Interior Brick Wall (7) to Lower Floor Wall.
6. Brick Wall (11) to Main Entrance Wall.

**NOTE:** Brick Wall (11), when properly positioned, is placed ON TOP of the Front Door Wall, not on the ledge. For proper positioning, the side locator tabs on Brick Wall (11) interlock on backside of Brick Walls (6) and (7).

7. Awnings (34) to six Sidewalk facing Windows on Front Side and Left Side Ground Floor Walls.

**NOTE:** The Awnings are designed to fit into the recessed area of the Window's top.

8. Loading Door Dock Roof (32) into Left Side Wall.
9. Loading Door Roof Dock Supports (33) into locator holes on Roof and Wall.

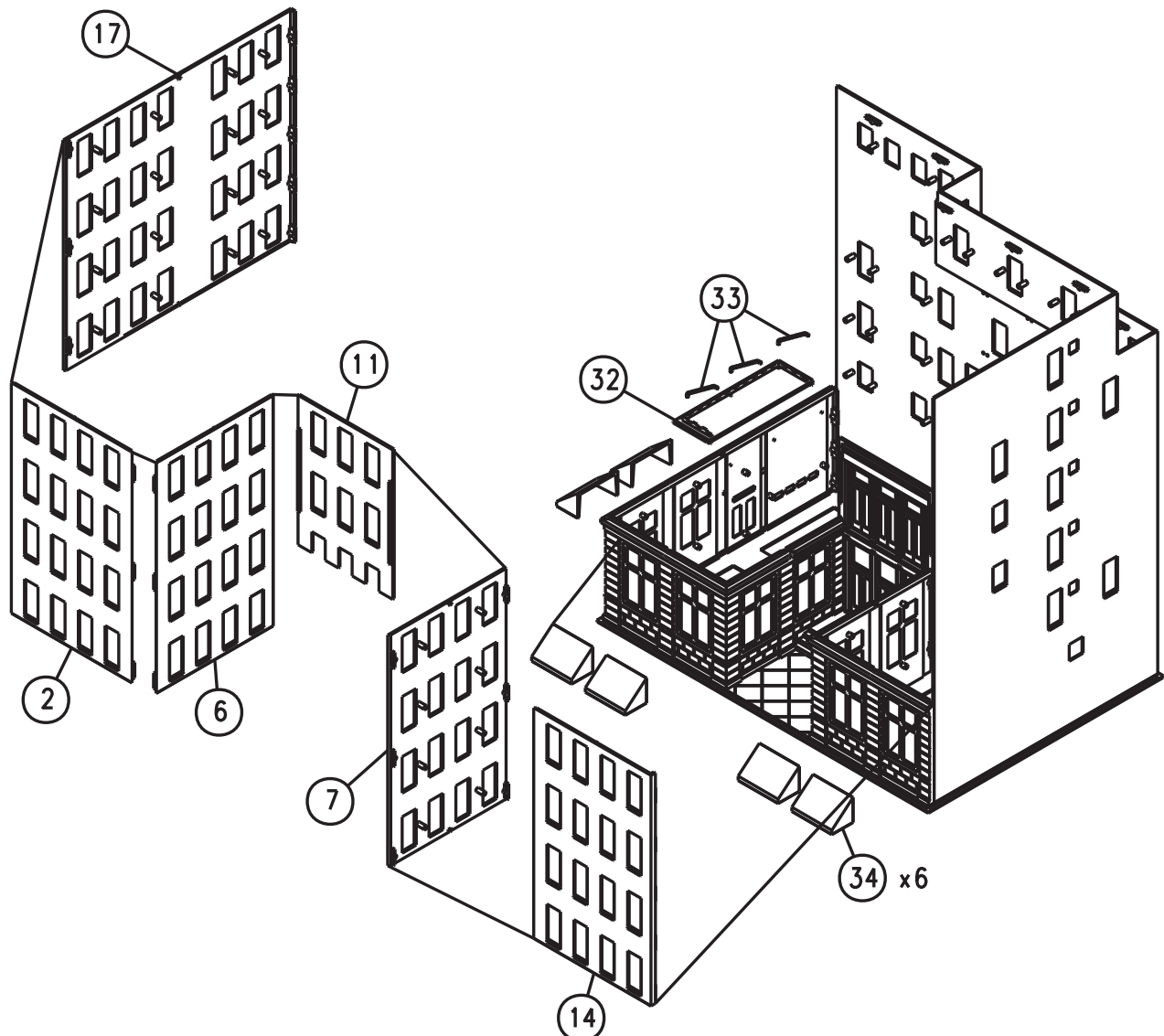

## **middle floor brick wall window assembly**

Assemble all parts to BACKSIDE of the Walls. When properly positioned, the Windows fit solidly into wall window opening; the Clear Part(s) fit onto locator tabs extending from Wall and trap the Windows in place. If desired, use glue on Windows and Clear Parts.

You have the option of arranging the "Open" and "Closed" Windows however you choose. **IMPORTANT** - Once you determine the location of the "Open" and "Closed" Windows, be sure to match those with "Open" and "Closed" (solid) Clear Parts. A suggested window arrangement is shown.

Assemble Windows and Clear Parts in Brick Walls (17), (2) and (11).

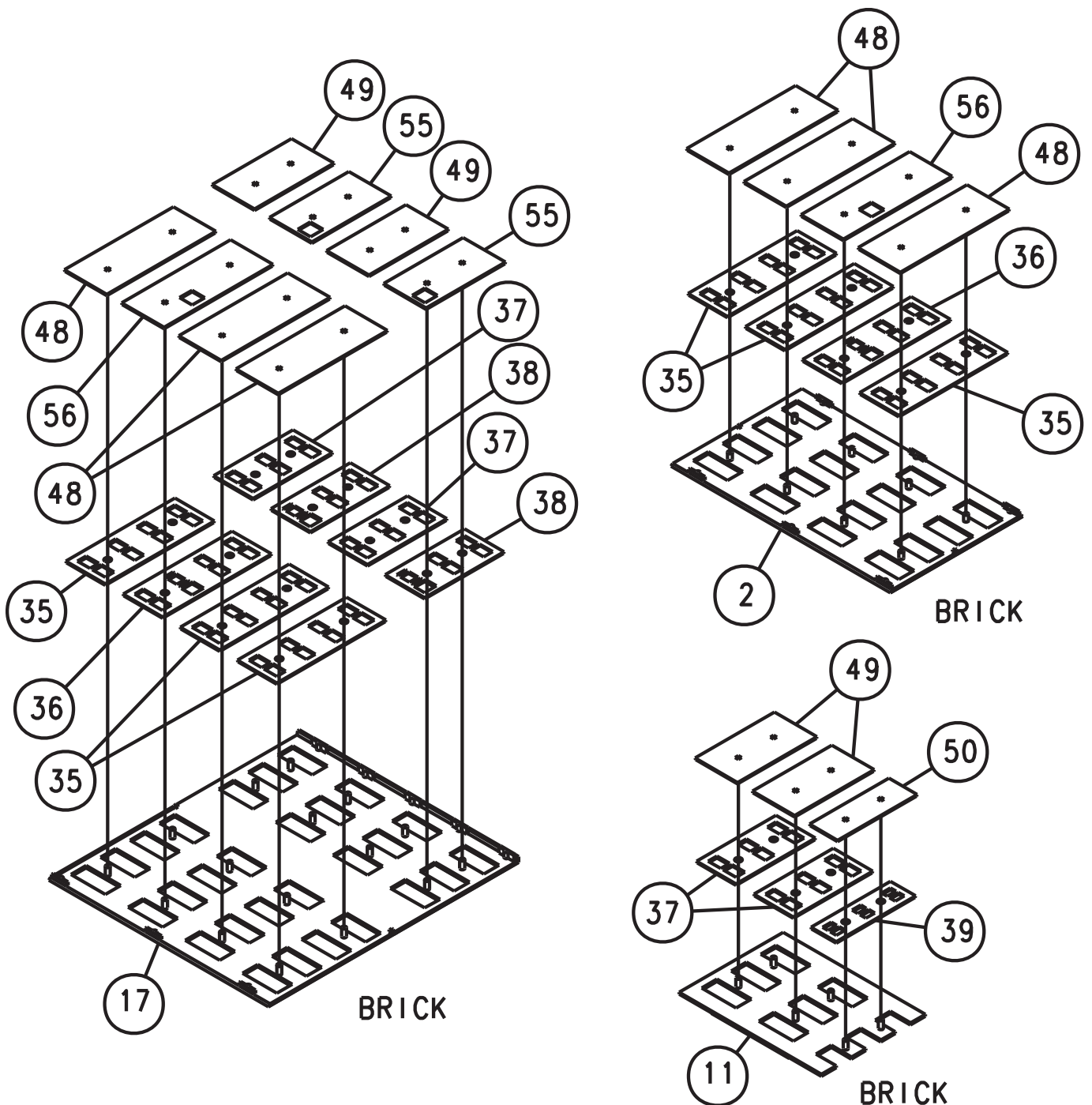

Figure B

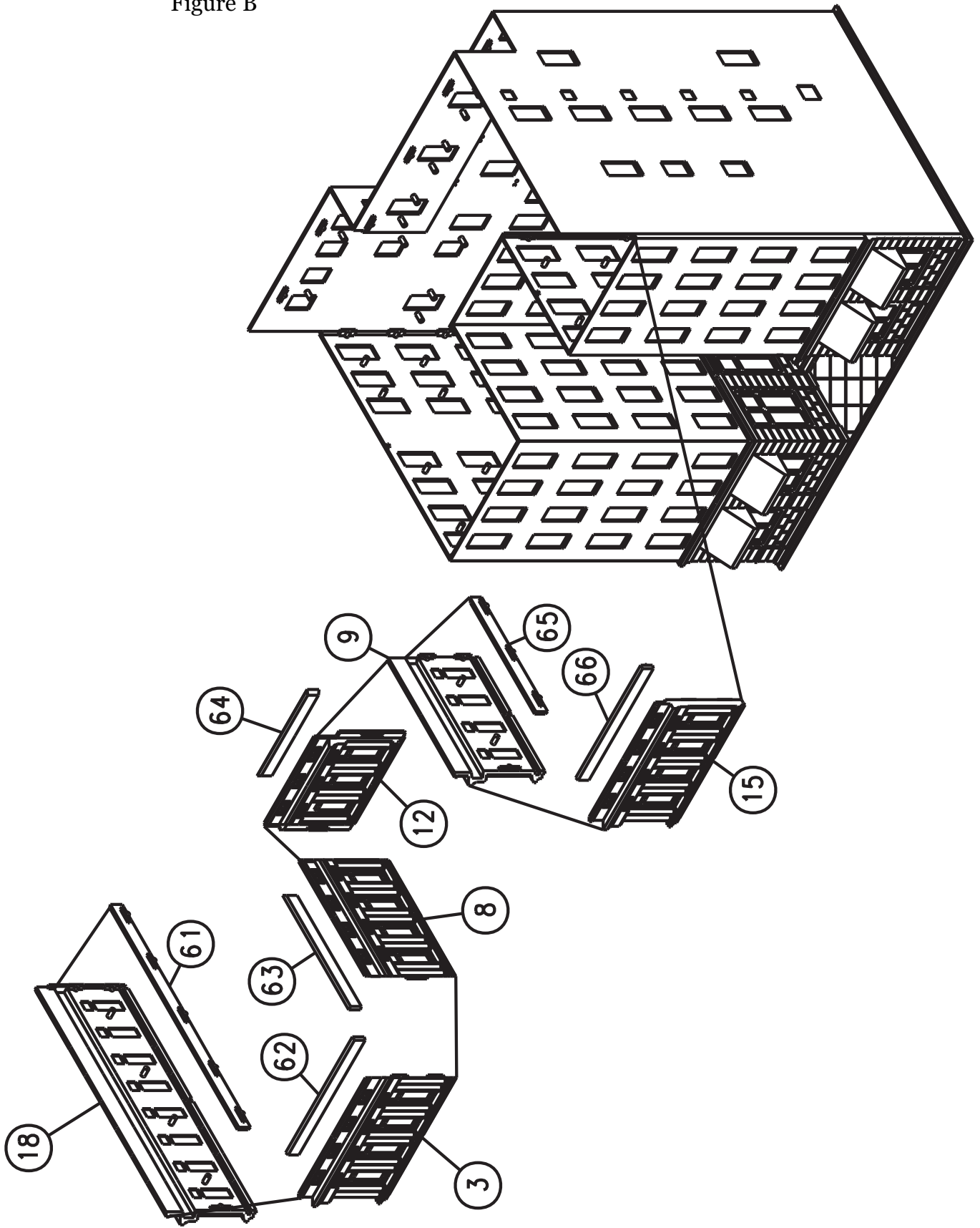
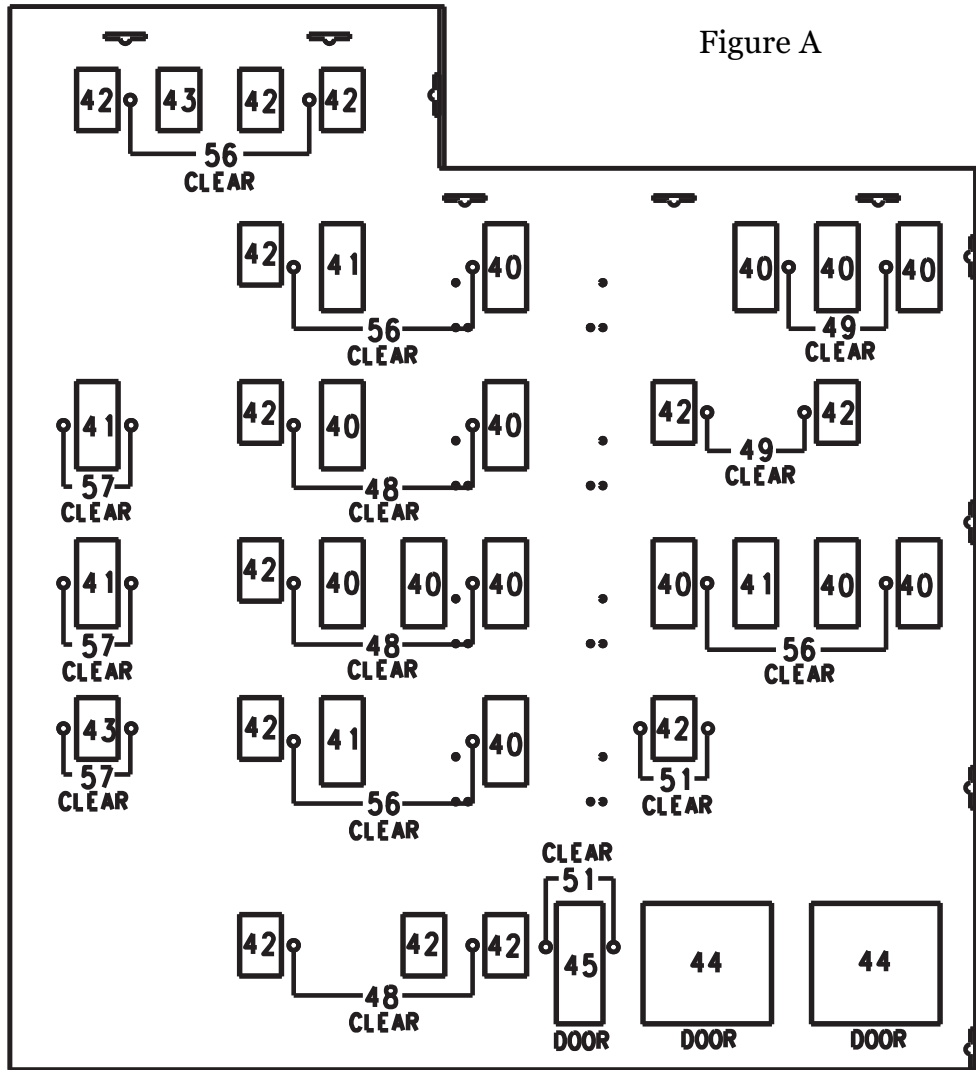
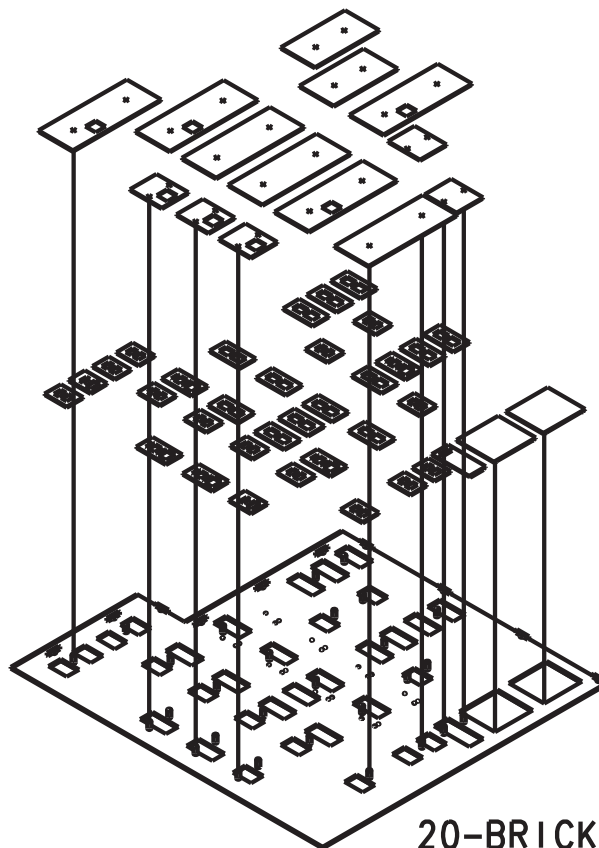

Figure A



20-BRICK



20-BRICK

## **detail parts and accessory assemblies**

### WALL VENTS:

Assemble Large (46) and Small (47) Wall Vents into appropriate locators on Right Side and Back Side Walls.

### FIRE ESCAPES:

**NOTE:** For proper positioning, make sure that tabs that fit into the Wall are all assembled facing outward in the same direction.

Assemble four Fire Escapes:

Assemble Side Railing (92) to Floor Railing (91).

Assemble End Railings (93) to Floor Railing (91) and Side Railing (92).

After glue has dried on these assemblies, the Fire Escapes can be mounted into the Right Side or Back Side locator holes opened during Right Side Wall or Back Wall Assembly. After mounting to Wall, place Ladders (94) and (95) into position on the Fire Escapes.

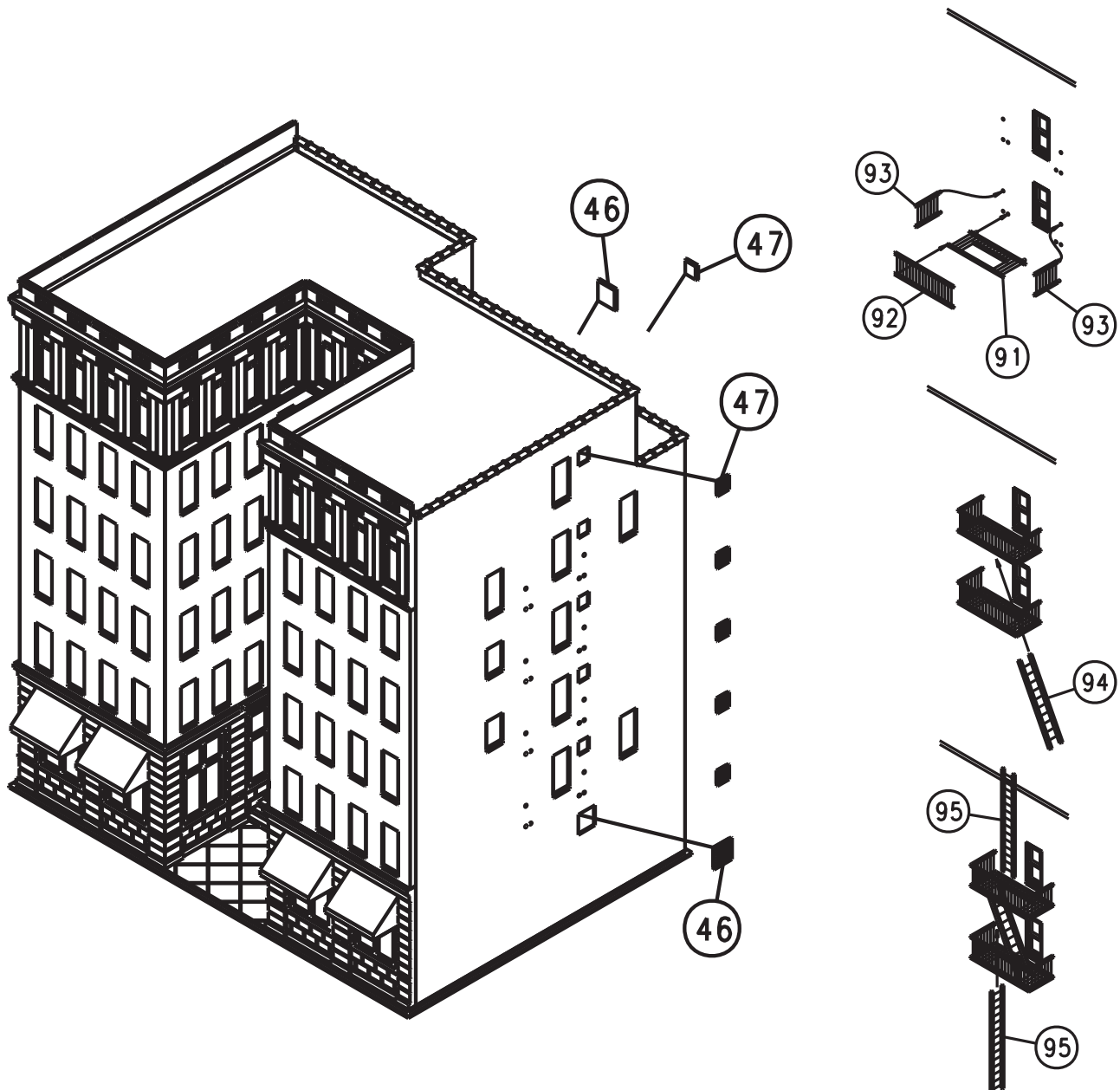

## **right side wall assembly**

### FIRE ESCAPES - WALL LOCATOR HOLES:

On the back side of Wall (19), locator holes have been designated as "**Optional Holes for Fire Escape.**" If you intend to assemble the four Fire Escapes to the Right Side Wall, drill out holes prior to window assembly. Drill from the back side, using a .039 inch (#61) drill bit. You may also use a hobby knife to open the holes, but take care not to make these holes oversized.

### WINDOW ASSEMBLY:

Assemble all parts to BACKSIDE of the Wall. When properly positioned, the Window fits solidly into wall window opening; the Clear Part(s) fit onto locator tabs extending from Wall and trap the windows in place. If desired, use glue on Windows and Clear Parts.

While a suggested window arrangement is shown below, you may position the "Open" and "Closed" windows however you choose. **IMPORTANT** - Once you determine the location of the "Open" and "Closed" windows, be sure to match those with "Open" and "Closed" (solid) Clear Parts.

The Windows and Clear Part requirements for Wall (19) are:

	<u>USE WINDOW</u>	<u>USE CLEAR PART</u>
6 Large "Closed" Windows	Part 40	Part 51
2 Large "Open" Windows	Part 41	Part 57
2 Small "Open" Windows	Part 43	Part 57

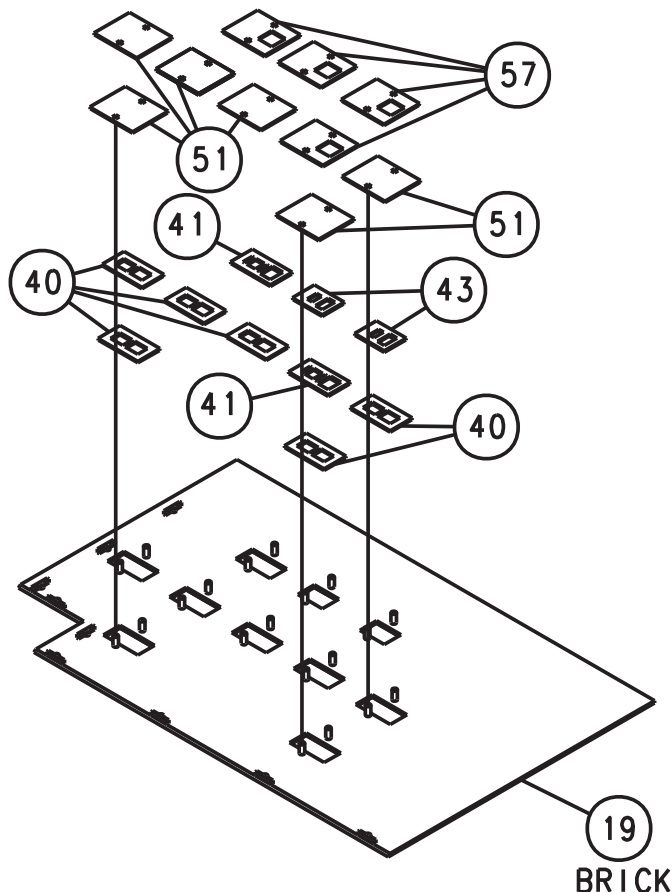



## **roof and sidewalk detailing accessories**

Your kit comes complete with optional Roof and Sidewalk Detailing Accessories. Some, such as Roof Vents Parts (11) and Fire Hydrants Parts (8), do not require assembly. Others require assembly as shown.

After assembly, position the accessories on or around your building as required.  
Suggested locations:

### **BUILDING ROOF TOP**

Elevator Shaft Access Panel  
Rotary Exhaust Vents  
Roof Access Door  
Water Tank  
Roof Vents

### **SIDEWALK**

Mail/Express Boxes  
Fire Hydrants

**NOTE:** Dry Fit each part before assembly. Glue should be applied sparingly to the assembly tabs.  
For added detail, parts can be individually painted before assembly.

### **ELEVATOR SHAFT ACCESS PANEL**

#### **ASSEMBLE IN SEQUENCE:**

1. Side Panel (2) to Panel (3).
2. Side Panel (4) to Panel (3).
3. Front Panel (5) to Side Panel (2) and (4).
4. Roof (1) to Walls (2), (3), (4), and (5).

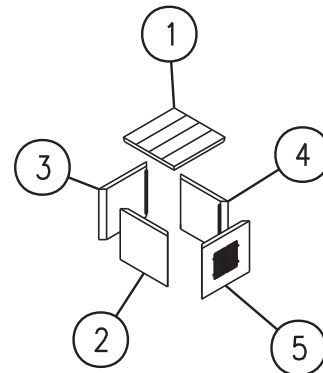

### **MAILBOXES**

1. Assemble Mailbox Halves (6) and (7).

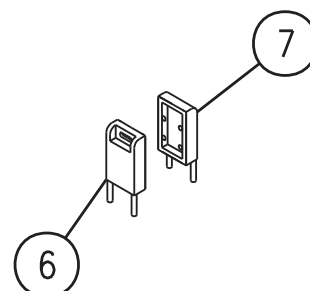

## READ PRIOR TO ASSEMBLY

TO ENHANCE THE AESTHETIC AND REALISTIC QUALITIES OF THIS BUILDING, PARTS HAVE BEEN DESIGNED AND MANUFACTURED IN SCALE PROPORTIONS. AS A RESULT, SOME PARTS ARE FRAGILE AND REQUIRE CARE IN ASSEMBLY. THEREFORE... EASY DOES IT. AS WITH ANY MODEL BUILDER KIT, A DEGREE OF PATIENCE IS REQUIRED TO ACHIEVE THE BEST RESULTS.

### ASSEMBLY HINTS

- Read through these instructions and examine the parts supplied to familiarize yourself with all aspects of the building prior to assembly.
- Remove the parts as needed, not at random.
- To remove the parts from the sprues, cut, not break, each part.
- However, when removing Clear Parts from the sprue, bend the Clear Part back and forth. The bending action will safely remove part from sprue.
- If you choose to paint any parts, we suggest you do so prior to assembly.
- To ensure a nice, tight fit, carefully remove all excess sprue marks with a modeling knife or hobby file. This is a necessity or parts will not fit properly.
- Follow the sequence guide to ensure correct placement of the parts.
- VERY IMPORTANT - Before gluing, dry fit the parts.
- Use glue sparingly, especially when assembling Window Frames and Clear Parts. These parts have been designed to tight tolerances, in many cases enabling you to trap the Window Frames between the Wall and the Clear Part, and therefore require only "tack" gluing.
- All Window Clear Parts are marked "**THIS SIDE UP.**" For proper assembly, be sure "**THIS SIDE UP**" is facing you and legible when assembling. This will properly orient the part to slide easily onto locator tabs.
- Prior to assembling a Window Clear Part, be sure you have matched "Open" and "Closed" Window Frames with "Open" and "Closed" (solid) Clear Parts (if applicable to your model). The Clear Parts, once mounted on the mounting tab, are difficult to remove from the tab. If the Clear Part must be removed, gently pry the Clear Part upward until loose. When mounting Window Frames, be careful that they are positioned correctly, according to the instructions of your specific model.
- Prior to assembly, brick areas can be enhanced by adding modeling mortar (if applicable for your model). We use Robert's Brick Mortar Formula. It's easy to apply and looks great. For product information, contact Robert's Products Co., P.O. Box 270057, Milwaukee, WI 53227.
- Use the full-color box lid as a helpful guide during assembly.
- Now it's time to break ground for the construction of your Cityscenes™ building. Take your time and have fun!

### RECOMMENDED TOOLS

**Modeling Knife** - For removing parts from sprue and trimming.

**Hobby File** - For removing sprue marks.

**Glue** - Preferably a liquid, easy-to-brush adhesive. Use it sparingly.

**3/8 - 1/2" Brush** - Helpful in spreading glue on larger areas.

**Tweezers** - For assembling smaller parts.

**Sandpaper or Emery Board** - For removing flash.

## **Decals**

Custom decals have been included with your kit and can be applied at your discretion. Application directions are provided on the back of the decal envelope.

### DAMAGED OR MISSING PARTS:

We take great care in ensuring that all parts are present and in good condition. In the unlikely event that a part is missing or damaged, our Service Department will be happy to assist you. For more information contact:



Service Department  
Bachmann Industries, Inc.  
1400 East Erie Avenue  
Philadelphia, Pennsylvania 19124

Phone: 1-800-356-3910

