



O SCALE PLASTICVILLE U.S.A.®

APARTMENT BUILDING - Item No. 45980

Snap-Fit • No glue necessary • Styled after authentic American prototype • Ages 14+

IMPORTANT - BEFORE STARTING:

- IF DECALS OR SIGNS ARE INCLUDED, APPLY PRIOR TO ASSEMBLY.
- CHECK PARTS AGAINST LIST OF PARTS.
- CAREFULLY TRIM ANY EXCESS PLASTIC FROM THE PARTS BEFORE ASSEMBLING.
- ALTHOUGH NO GLUE IS NECESSARY, YOU MAY ALSO WISH TO ADD A FEW DROPS OF STYRENE CEMENT TO JOINTS FOR PERMANENT CONSTRUCTION.

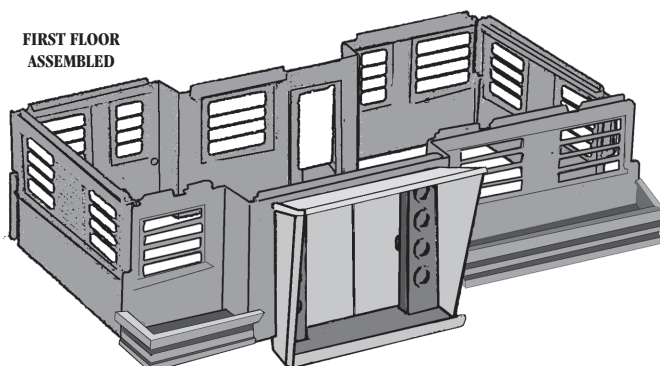
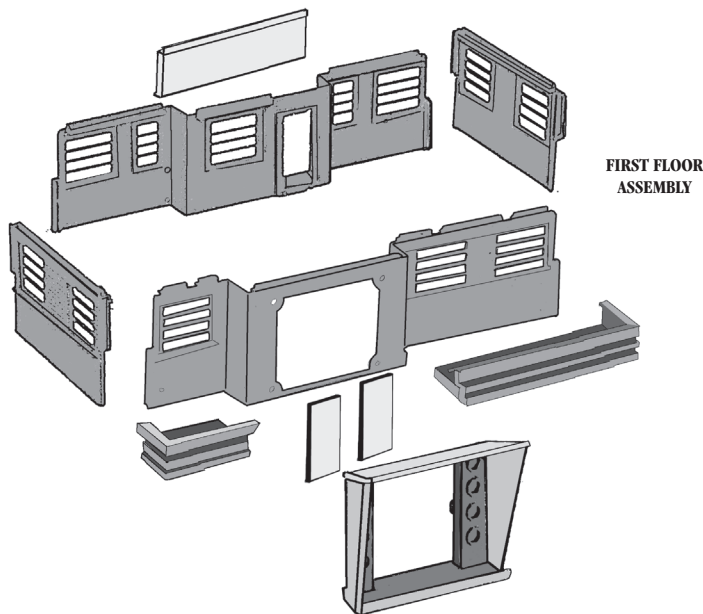

LIST OF PARTS

QTY	PART NAME
1	ROOF
1	UPPER FRONT WALL with 1 DOOR, 1 PICTURE WINDOW & 2 BARRED WINDOWS
1	BOTTOM FRONT WALL with 3 BARRED WINDOWS & LARGE ENTRY WAY
2	BACK WALLS with 5 BARRED WINDOWS & 1 DOOR
4	END WALLS
1	ENTRY WAY DOOR JAMB
5	DOORS
1	ROOF ENTRANCE SIDE WALL PEGGED
1	ROOF ENTRANCE SIDE with HOLES
1	ROOF HATCH "L" SHAPED
1	UPPER WALL DOOR SIDE BALCONY
1	UPPER WALL WINDOW SIDE BALCONY
1	LONG GROUND FLOOR TRIM FOR UNDER TWIN BARRED WINDOWS (BOTTOM)
1	SHORT GROUND FLOOR TRIM FOR UNDER SINGLE BARRED WINDOW (BOTTOM)
1	UPPER FLOOR REAR BALCONY WALL
2	ANTENNAS
1	CHAIR
1	CHAISE LOUNGE

ASSEMBLY

- Step 1* Read & identify ALL parts, then proceed to assemble in the following manner.
- Step 2* Install ALL 5 doors by snapping hinge pins into jamb.
- Step 3* Install entry jamb; in first floor front wall.
- Step 4* Install long & short ground floor trim.
- Step 5* Install upper floor front balcony small & large parts.
- Step 6* Install upper floor rear balcony wall.
- Step 7* Slide 4 ground floor walls together.
- Step 8* Slide upper floor walls together and set on top of previous floor.
- Step 9* Snap roof on upper floor.
- Step 10* Put "L" shaped hatch door between the two sides of the roof entrance, being sure pins on hatch are in holes of entrance walls. Push together and place on top of hole in roof.
- Step 11* Put antennas in holes on either corner of roof.
- Step 12* Place furniture where desired.

NOTE: A modeler's knife or file is recommended for removal of parts from the sprue and for trimming flash.

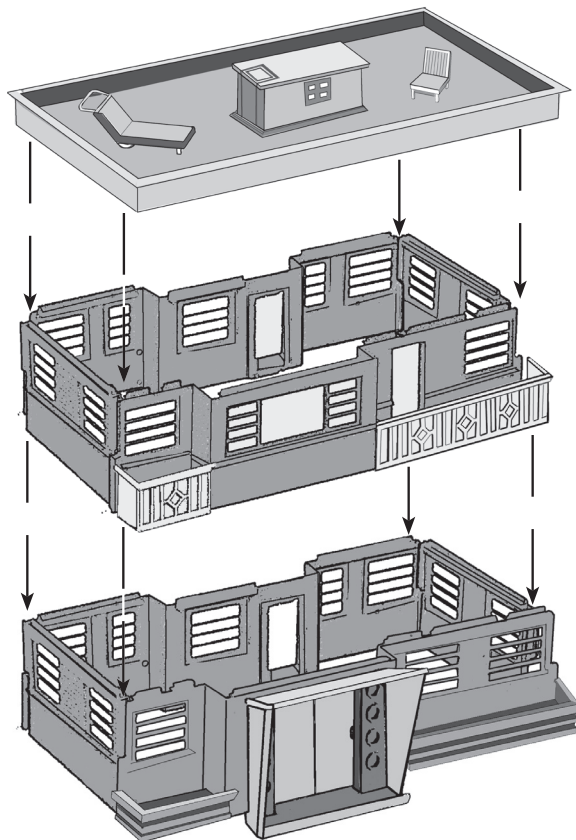
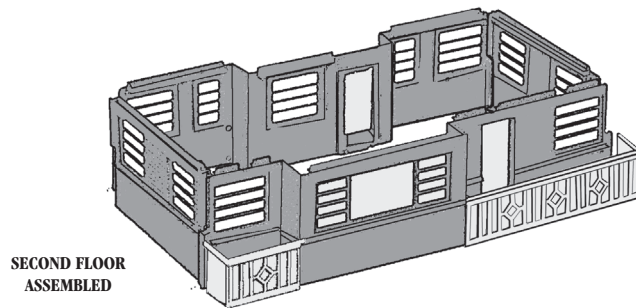
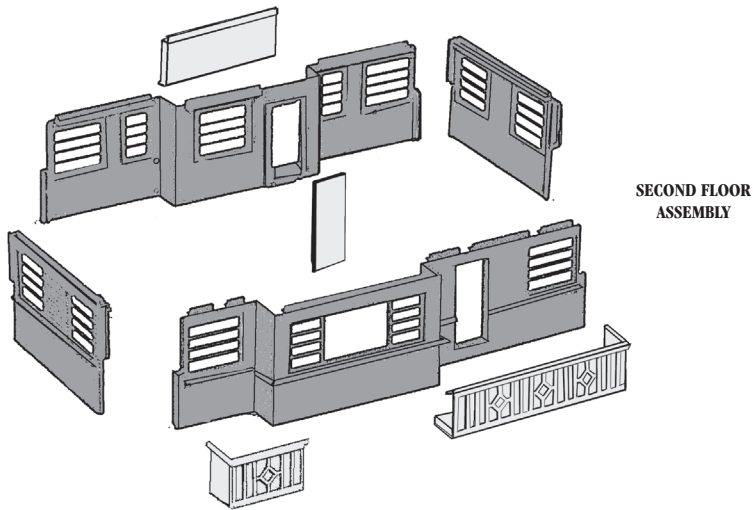

BACHMANN INDUSTRIES, INC.
1400 EAST ERIE AVENUE
PHILADELPHIA, PA 19124
www.bachmanntrains.com



PRINTED IN CHINA