



HO SCALE PLASTICVILLE U.S.A.®

DRIVE-IN BURGER STAND - Item No. 45434

Snap-fit • No glue necessary • Styled after authentic American prototype • Ages 14+

IMPORTANT - BEFORE STARTING:

- IF DECALS OR SIGNS ARE INCLUDED, APPLY PRIOR TO ASSEMBLY.
- CHECK CONTENTS AGAINST LIST OF PARTS.
- CAREFULLY TRIM ANY EXCESS PLASTIC FROM THE PARTS BEFORE ASSEMBLING.
- ALTHOUGH NO GLUE IS NECESSARY, YOU MAY ALSO WISH TO ADD A FEW DROPS OF STYRENE CEMENT TO JOINTS FOR PERMANENT CONSTRUCTION.

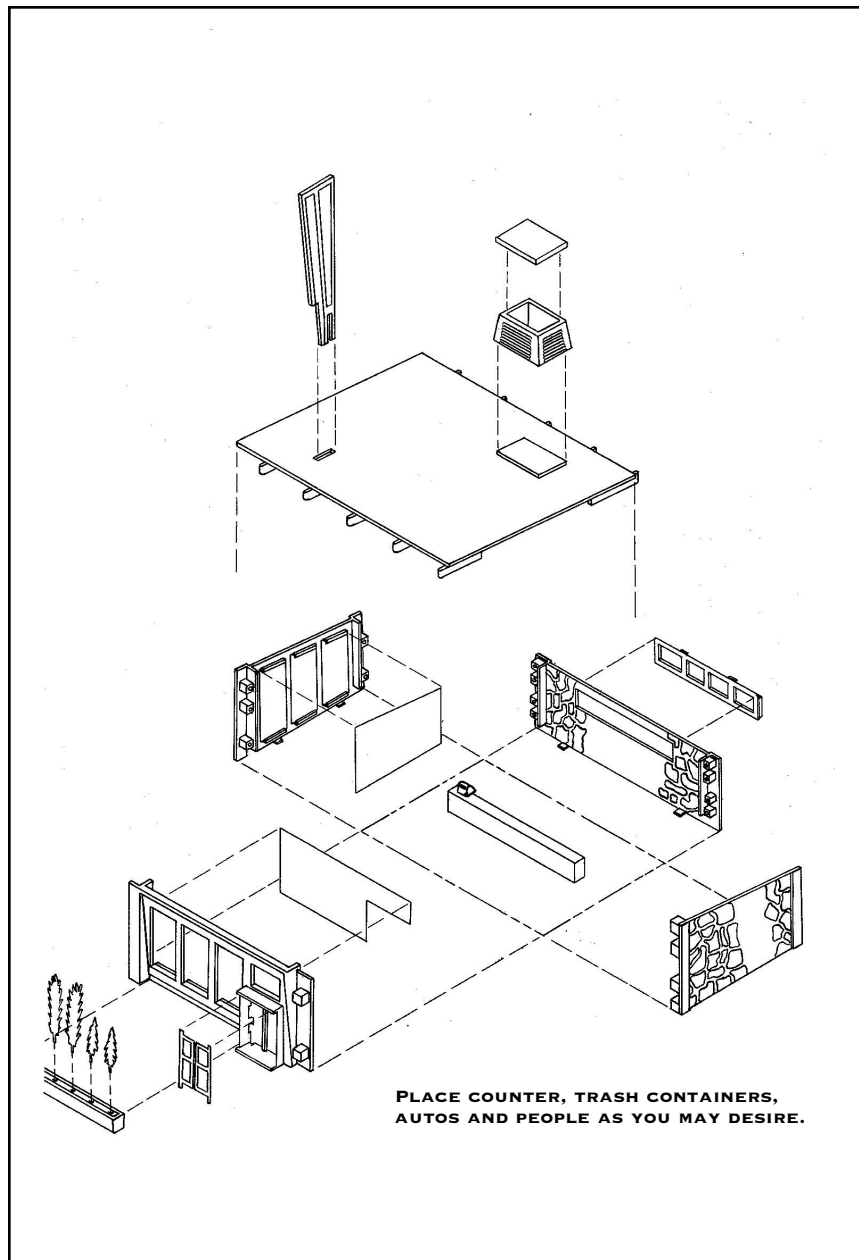

LIST OF PARTS

PART NO	PART NAME	QTY
1	FRONT WALL	1
2	BACK WALL	1
3	SIDE WALLS	2
4	ROOF	1
5	CHIMNEY	1
6	CHIMNEY CAP	1
7	MARQUEE	1
8	BACK WINDOW	1
9	BACK WINDOW PANE	1
10	SIDE WINDOW PANE	1
11	FRONT WINDOW PANE	1
12	TRANSIT WINDOW PANE	1
13	COUNTER	1
14	FOUNTAIN ACCESSORIES	2
15	DOORS	2
16	FIGURES	3
17	CARS	2
18	CARS WHEELS	16
19	CAR WINDOW INSERTS	2
20	CAR WHEEL AXLES	4
21	TREES	6
22	TREE BASE	1
23	MARQUEE DECAL	1
24	DECAL SHEET	1
25	FLOOR CARD	1

